

INSTALLATION INSTRUCTIONS

Victorian Single Control Bar Faucet

Model D35402400

Thank you for selecting DXV by American Standard.
To ensure that your installation proceeds smoothly,
please read these instructions carefully
before you begin.

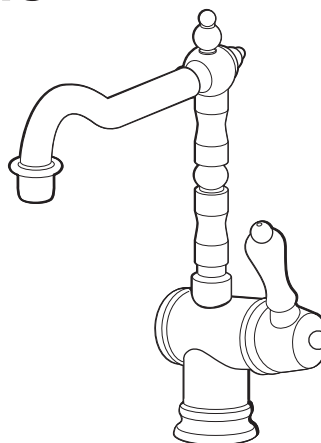

DXV

AMERICAN STANDARD

RECOMMENDED TOOLS AND MATERIALS

Most of the procedures require the use of common tools and materials, which are available from hardware and plumbing, supply stores. It is essential that the tools and materials be on hand before work is begun.



Channel Locks



Adjustable Wrench

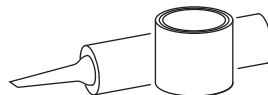

Plumbers' Putty or Caulking

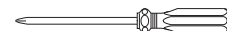

Phillips Screwdriver



Flat Blade Screwdriver

ROUGHING-IN DIMENSIONS:

- For reference

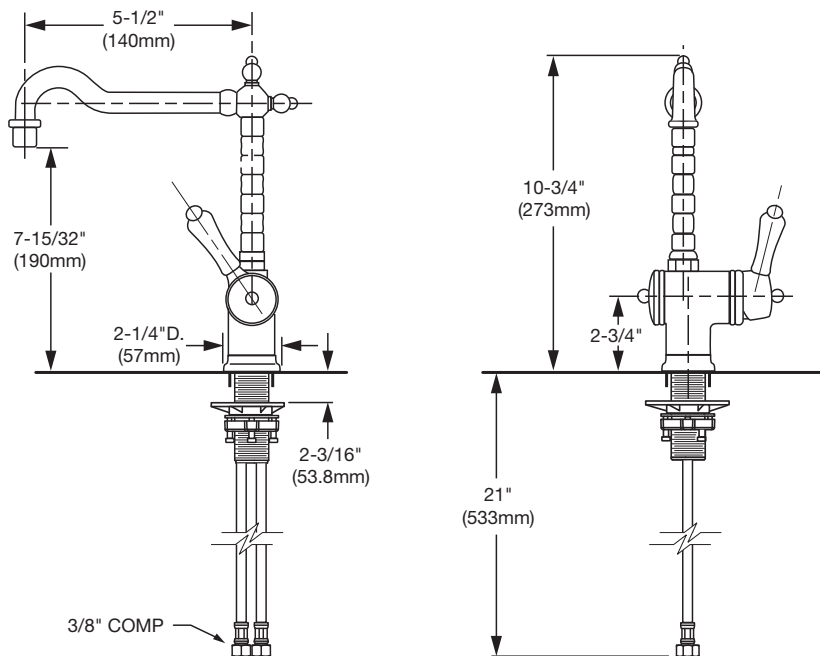

NOTE: Bore hole size is 1-3/8"

In the United States:

DXV by American Standard
One Centennial Avenue
Piscataway, New Jersey 08855
Attention: Director of Customer Care

For residents of the United States, warranty
information may also be obtained by calling
the following toll free number: (800) 227-2734
www.DXV.com

In Canada:

DXV by American Standard
5900 Avebury Road
Mississauga, Ontario
L5R 3M3
Canada

Toll Free: 1-800-387-0369
Local: 905-306-1093
Fax: 1-800-395-1498
www.DXV.ca

In Mexico:

DXV by American Standard
Via Morelos 330
Col. Santa Clara Coatitla
Ecatepec, Estado de México 55540

Toll Free: 01-800-8391200
www.DXV.mx

SAVE FOR FUTURE USE

1 INSTALL FITTING

CAUTION Turn off hot and cold water supplies before beginning.

- Make certain the O-RING (2) is properly seated in recess of FAUCET BASE (3).
- Insert HOSE (9), SHANK (10) through center hole of sink or mounting surface.
- Assemble three BRASS SCREW (8) into the FIXATION RING (7).
- Assemble SUPPORT PLATE (5) METAL WASHER (6), and FIXATION RING (7) onto SHANK (10) from underside of sink. Hand tighten the FIXATION RING (7) and check that FAUCET (1) is centered.
- Use a screwdriver to tighten SCREW (8) on FIXATION RING (7). Work your way around FIXATION RING (7), tightening the screws slightly each time until all are snug to ensure even pressure.

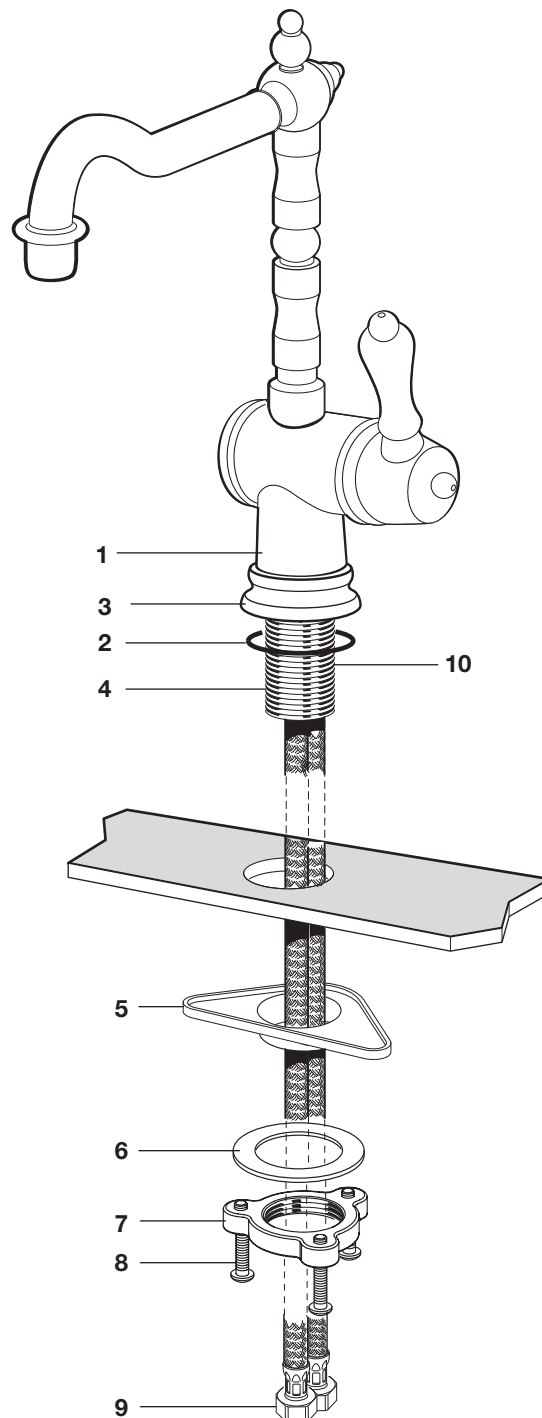

2 MAKE WATER SUPPLY CONNECTIONS

- Turn off hot and cold water supplies before beginning.
- Connect FLEXIBLE SUPPLIES (1, 2) directly to wall supplies. Connection on fitting supplies are 3/8" compression. Connect left supply (Marked Red) to Hot and right supply (Marked Blue) to Cold wall supply. Use adjustable wrench to tighten connections. Do not over tighten. Faucet supplies are 21" long from faucet base.

Note: If additional supply length is required, installer must purchase additional parts separately.

Important: If SUPPLY HOSES (1, 2) are too long, loop as illustrated to avoid kinking.

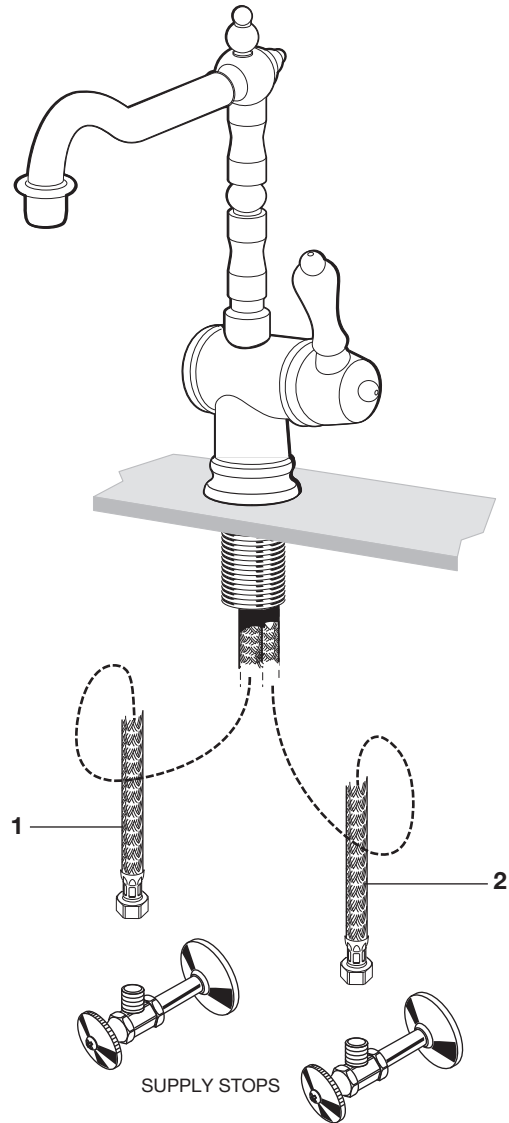

3 TEST INSTALLED FAUCET

- Move HANDLE (1) into "off" position.
- Turn on water supplies and check all connections for leaks. ➡

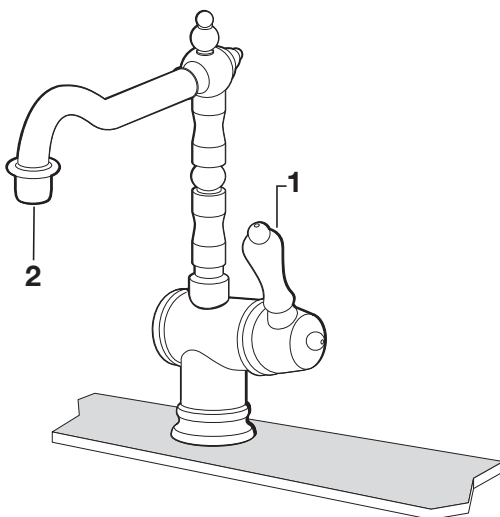

TROUBLE SHOOTING

Low water flow from faucet:

- Remove AERATOR (2) and clean if necessary.

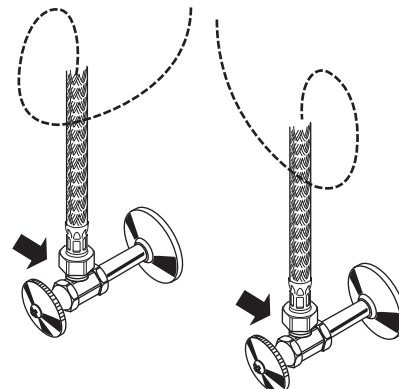



AMERICAN STANDARD

Victorian Single Control Bar Faucet

MODEL NUMBER

D35402400

Replace the "YYY" with
appropriate finish code

POLISHED CHROME	100
CARBON BRONZE	110
ULTRA STEEL	355

