

INSTRUCTIONS FOR KITCHEN FAUCETS:

1. Turn off water supply.
2. Snap out button, remove screw.
3. Remove handle together with yoke by lifting up and back.
4. Unscrew retainer ring.
5. Replace screw into cartridge assembly.
6. Remove cartridge assembly by gripping the head of the screw with pliers and pulling up.
7. Insert new cartridge assembly into faucet body.
8. Screw in the retainer ring hand tight.
9. Insert handle pivot into pivot groove of retainer ring. Pivot handle down so that stem goes into the yoke. Replace screw and snap in button.

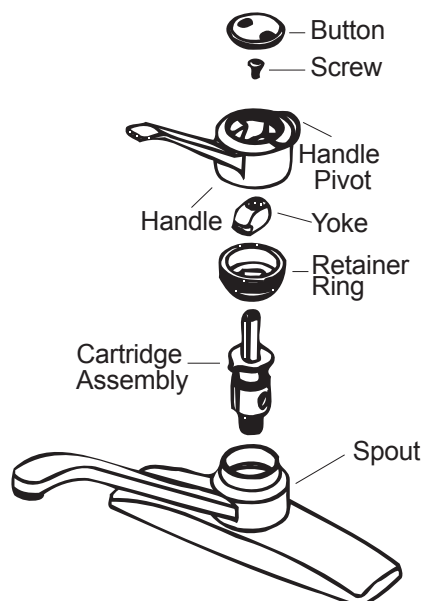

INSTRUCTIONS FOR LAVATORY FAUCETS:

1. Turn off water supply.
2. Remove button, screw & handle.
3. Unscrew collar nut.
4. Pull cartridge assembly from faucet body.
5. Insert new cartridge assembly into faucet body and tighten collar nut.
6. Reassemble in reverse order.

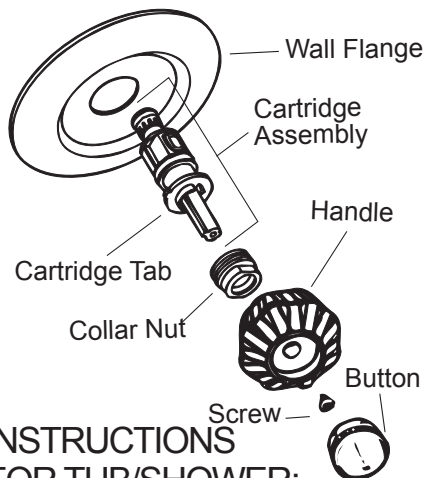

INSTRUCTIONS FOR TUB/SHOWER:

1. Turn off water supply.
2. Remove button, screw & handle.
3. Remove wall flange and sleeve.
4. Unscrew collar nut.
5. Pull cartridge assembly from valve body.
6. Insert new cartridge assembly into valve body and tighten collar nut.
7. Reassemble in reverse order.

Manufactured for/
Fabrique pour/
Fabricado para:
Lincoln Products
Industry, CA 91748
© Copyright 2010