



SYMMONS®
Lever Diverter
4-458-OFL-STN
Installation Brief



Need Help?

Contact Symmons customer service at
(800) 796-6667, (781) 848-2250
Email: customerservice@symmons.com
Monday - Friday 8:00 am - 7:30 pm EST

Product Highlights

- Two-way diverter
- Satin nickel finish



Please check Symmons website for technical help,
the latest product information and warranty policy.
Website: www.symmons.com/service

Parts Assembly

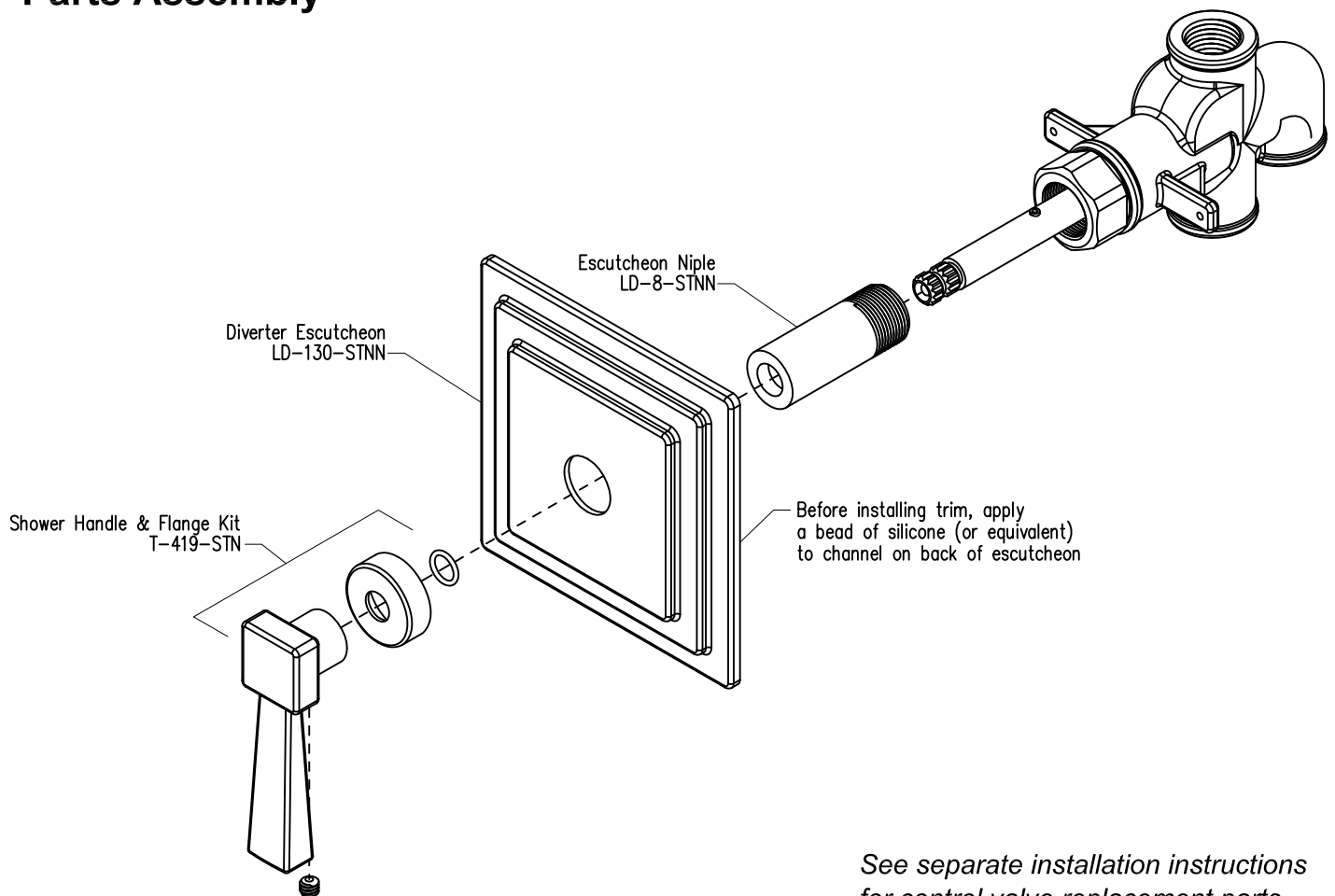

*See separate installation instructions
for control valve replacement parts.*

Dimensions

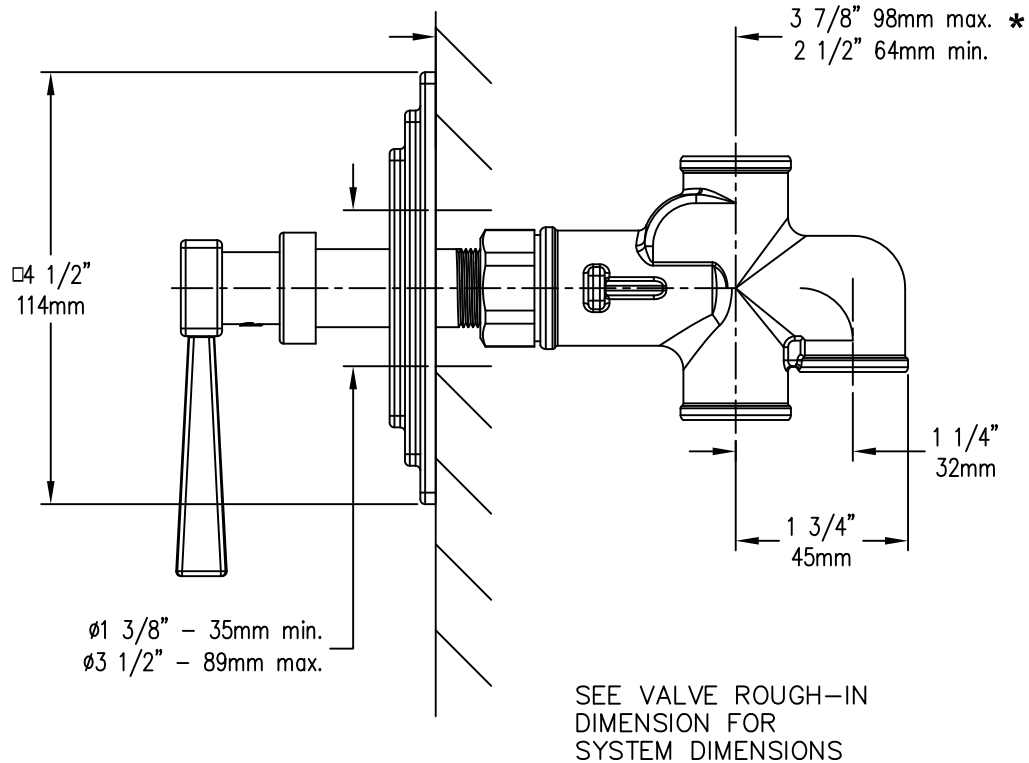

Note:

- (1) Dimensions noted with * are applied when diverter valve is installed alone. When diverter valve is coupled with a main control valve, then dimension is determined by main control valve rough-in dimension.
- (2) Dimensions and product structure are subject to change without notice.

Symmons Industries, Inc. ■ 31 Brooks Drive ■ Braintree, MA 02184
(800) 796-6667, (781) 848-2250 ■ Fax (800) 961-9621, (781) 843-3849
Website: www.symmons.com ■ Email: customerservice@symmons.com