

## 2 INSTALL VALVE TRIM

- Fit ESCUTCHEON SEALS (1) into underside of VALVE ESCUTCHEONS (2).
- Thread the VALVE ESCUTCHEONS (2) into the VALVE BODIES (3). Align the HANDLE STEM (4) with the SLEEVE (5) as necessary. Thread the VALVE ESCUTCHEON (2) into the BODIES (3) until the ESCUTCHEON (2) contacts the finished deck.

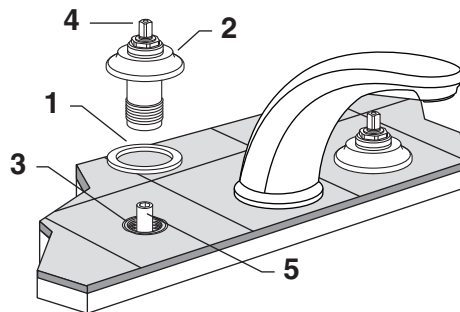

## 3 INSTALL HANDLE TRIM

- Turn HANDLE STEM (1) to "OFF" position.
- Place the HANDLE ADAPTER (2) on the HANDLE STEM (1).
- Position LEVER HANDLE (4) and place on ADAPTER (2). Install the HANDLE SCREW (5) and tighten securely.

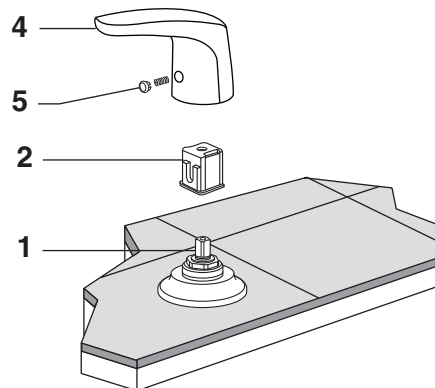

## 4 TEST INSTALLED FAUCET

- Remove STREAM STRAIGHTENER (1). With handles in OFF position, turn on water supplies and check all connections for leaks.
- Operate both handles to flush water lines thoroughly. Replace STREAM STRAIGHTENER (1).

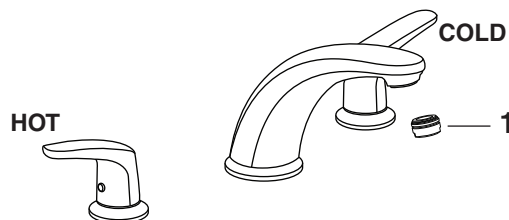

## COLONY® PRO DECK MOUNT TUB FILLER

MODEL NUMBER

**T075.900**

Replace the "YYY" with appropriate finish code

POLISHED CHROME	002
LEGACY BRONZE	278
SATIN NICKEL	295

*American Standard*

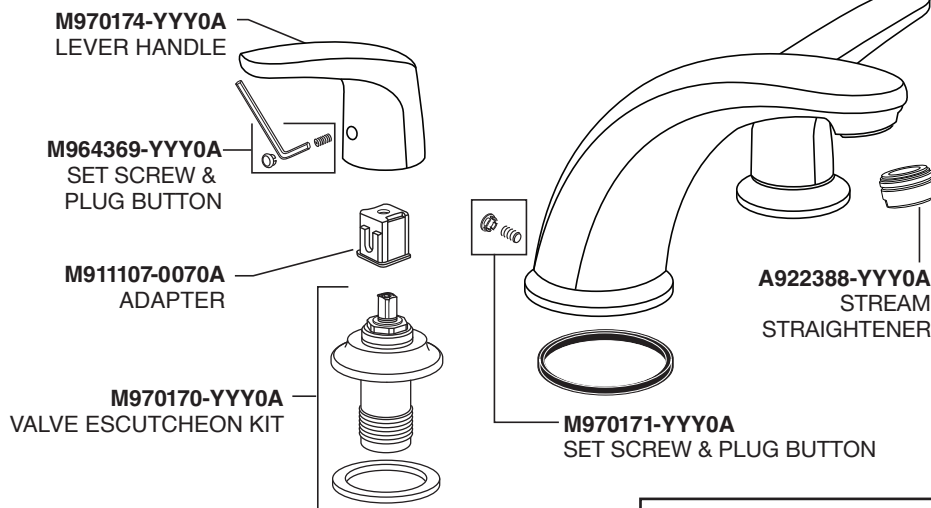

### HOT LINE FOR HELP

For toll-free information and answers to your questions, call: 1 (800) 442-1902  
 Mon. - Fri. 8:00 a.m. to 8:00 p.m. EST  
 Saturday 10:00 a.m. to 4:00 p.m. EST  
 IN CANADA 1-800-387-0369  
 (TORONTO 1-905-306-1093)  
 Weekdays 8:00 a.m. to 7:00 p.m. EST  
 IN MEXICO 01-800-839-1200



PART OF **LIXIL**