

ROD HANGER 325

Steel Side Beam Attachment

- Size Range: 3/8", 1/2", 5/8", 3/4", 7/8", and 1" rod sizes
- Surface Finish: Electro-zinc plated, Black
- Structural attachment fastened to the wall or the side of a joist to support hanger rod
- Conforms with Federal Specification WW-H-171 (Type 35), Manufacturers Standardization Society ANSI/MSS-SP-58 (Type 34); install in accordance with ANSI/MSS-SP-69



NOTE: Follow fastener manufacturer's recommended shear and pull-out strength when fastening to the structure.

Part Number	RS	A	B	Max. Rec. Load (lbs)	
				w/ Lag Screw	w/ Bolt to Steel
Plain Finish					
3250037PL	3/8"	1-5/32"	7/16"	650	1150
3250050PL	1/2"	1-5/32"	9/16"	650	1150
3250062PL	5/8"	1-3/8"	11/16"	850	2000
3250075PL	3/4"	1-3/4"	13/16"	900	3500
3250087PL	7/8"	2-1/2"	15/16"	900	3600
3250100PL	1"	2-1/2"	1-1/16"	900	3700
Electro-zinc Plated					
3250037EG	3/8"	1-5/32"	7/16"	650	1150
3250050EG	1/2"	1-5/32"	9/16"	650	1150
3250062EG	5/8"	1-3/8"	11/16"	850	2000
3250075EG	3/4"	1-3/4"	13/16"	900	3500
3250087EG	7/8"	2-1/2"	15/16"	900	3600
3250100EG	1"	2-1/2"	1-1/16"	900	3700

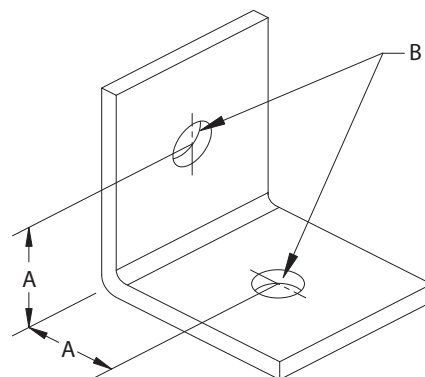

ROD HANGER 326

Universal Steel Side Beam Attachment

- Size Range: 3/8" rod size
- Surface Finish: Electro-zinc plated, Black
- Structural attachment fastened to the wall or the side of a joist to support hanger rod, where either 3/8" or 1/2" fasteners can be used to reduce inventories
- Conforms with Federal Specification WW-H-171 (Type 35), Manufacturers Standardization Society ANSI/MSS-SP-58 (Type 34); install in accordance with ANSI/MSS-SP-69



NOTE: Follow fastener manufacturer's recommended shear and pull-out strength when fastening to the structure.

Part Number	RS	A	B	Max. Rec. Load (lbs)	
				w/ Lag Screw	w/ Bolt to Steel
Plain Finish					
3260037PL	3/8"	1-5/32"	7/16"	560	620
Electro-zinc Plated					
3260037EG	3/8"	1-5/32"	7/16"	560	620

