

# Specification

PERRIN & ROWE<sup>®</sup>  
MAY FAIR LONDON

## U.3785

### Country Wall Mounted Tub Spout



#### Finishes

- Polished Chrome
- Polished Nickel
- Satin Nickel
- Inca Brass
- Polished Chrome/Inca Brass
- Satin Nickel/Inca Brass
- Polished Nickel/Inca Brass

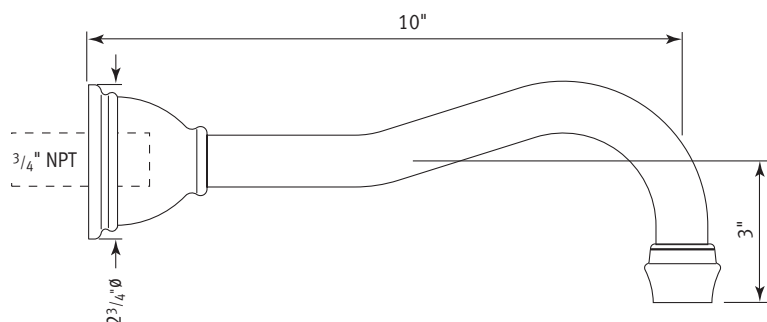

#### Approvals:

IAPMO A112.18.1.M

#### Packed Weight:

2Kg / 4½ lbs

#### Temp Range:

Min 1°C / 34°F

Max 85°C / 185°F

#### Recommended working pressure:

Min 1 bar / 15psi

Max 5 bar / 75 psi

# Specification

**PERRIN & ROWE**  
MAYFAIR LONDON

## U.3785

### Country Wall Mounted Tub Spout



#### Parts Breakdown

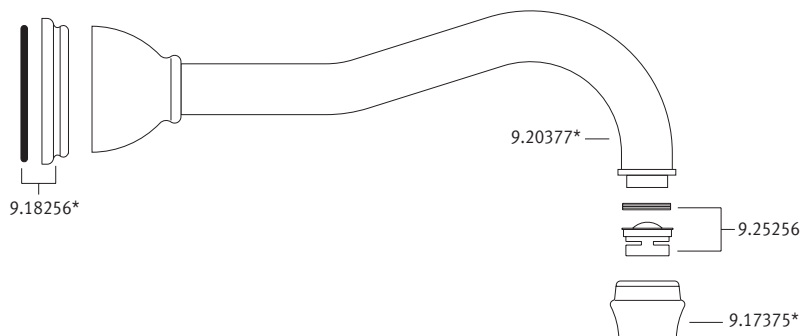

Where \* Indicated Specify Color.