

APPLICATION:

PRODUCT NAME:

DrainKing WASTE VALVE

JOB NAME:

☐ _____ SPECIAL CONFIGURATION
(CHECK BASE MODEL AND OPTIONS)

QUANTITY:

ITEM NO.:

MODEL:

☐ 22349 w/ LOCKING BASKET STRAINER

OPTIONS OR MODIFICATIONS:

☐ OTHER _____

FEATURES:

- * DUAL TEFLON SEALS
- * STAINLESS STEEL BALL
- * CAST RED BRASS BODY
- * EXTRA STURDY STAINLESS STEEL CLAMPING RING
- * "CLEAR THROUGH" OPENING - NO NEED TO DISASSEMBLE IF SNAKING IS REQUIRED
- * INDUSTRY STANDARD "SEALING" ANGLE - FITS FLUSH TO STANDARD STAINLESS STEEL SINKS
- * STAINLESS STEEL LOCKING BASKET STRAINER
- * 1/4 TURN FULLY OPENS AND CLOSES VALVE

DRAIN RATE:

- * 12.0 GPM

SHIPPING WEIGHT

- * 5.0 LBS

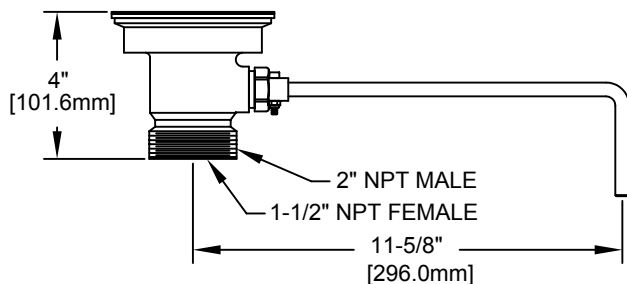
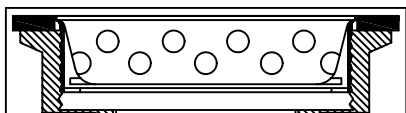

ROUGH-IN:

DRAIN:

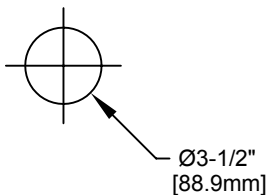

ANSI/A112.18.1M

FISHER

FISHER MANUFACTURING COMPANY

TOLL FREE: 800-421-6162 - FAX: 800-832-8238

information@fisher-mfg.com - www.fisher-mfg.com

APPLICATION:

PRODUCT NAME:

**DrainKing WASTE VALVE
ROUGH CHROME**

JOB NAME:

☐ SPECIAL CONFIGURATION
CHECK BASE MODEL AND OPTIONS

QUANTITY:

ITEM NO.

MODEL:

☐ 28983 w/ LOCKING BASKET STRAINER

OPTIONS OR MODIFICATIONS:

- ☐ SUPPLY LINES (24" OR 36") CIRCLE LENGTH
☐ ADD-ON FAUCET (6", 8", 10", 12", 14", 16") CIRCLE
☐ IN-LINE DUAL CHECK VALVE
☐ HANDLES (CROSS OR WRIST) CIRCLE STYLE
☐ VANDAL RESISTANT KIT
☐ OTHER _____

FEATURES:

- * DUAL TEFLON SEALS
- * STAINLESS STEEL BALL
- * CAST RED BRASS BODY, CHROME PLATED
- * EXTRA STURDY STAINLESS STEEL CLAMPING RING
- * "CLEAR THROUGH " OPENING - NO NEED TO DISSASSEMBLE IF SNAKING IS REQUIRED
- * INDUSTRY STANDARD "SEALING" ANGLE - FITS FLUSH TO STANDARD STAINLESS STEEL SINKS
- * STAINLESS STEEL LOCKING BASKET STRAINER
- * 1/4 TURN FULLY OPENS AND CLOSES VALVE

DRAIN RATE:

- * 12 GPM

SHIPPING WEIGHT

- * 5.0 LBS

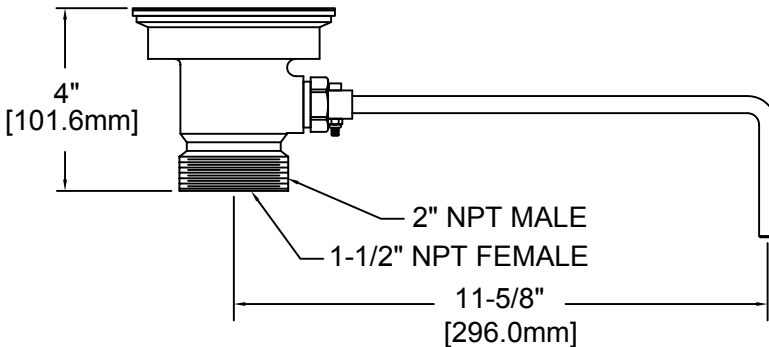
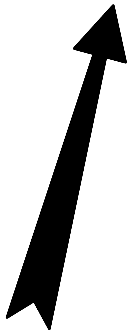
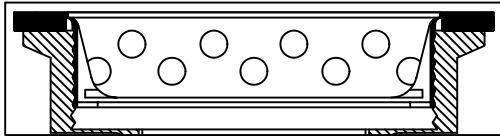

ROUGH-IN:

DRAIN:

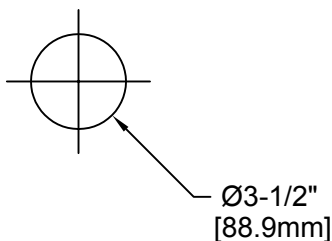

ANSI/A112.18.1M

FISHER

FISHER MANUFACTURING COMPANY

TOLL FREE: 800-421-6162 - FAX: 800-832-8238

information@fisher-mfg.com - www.fisher-mfg.com