

# For Residential and Commercial Applications

Job Name		Engineer / Architect	
Job Location		Wholesaler	
Submittal Date		Contractor	

## EU2 Series Safety+PLUS® Appliance Excess Flow Valve - Flare x Male Iron Pipe

**Use:** For use with natural, manufactured, mixed, liquefied petroleum gases and LP gas-air mixtures

### Design Features:

- **Helps prevent gas fires & explosions** due to gas line ruptures or disconnects at the appliance
- **Automatic valve activation** immediately restricts gas flow to a non-hazardous level to help avert a dangerous build up of gas in the home
- **Automatic Reset** once the gas line has been properly repaired
- **24 hour, maintenance-free protection** for the life of the product with no parts to wear, break or misalign over time
- **100% performance tested**

### Operating Specifications:

**Temperature:** 32° to 150°F

**Pressure:** standard line pressures up to 1/2 psi maximum

### Installation:

**Omni-directional** - can be installed in any orientation, horizontal to vertical

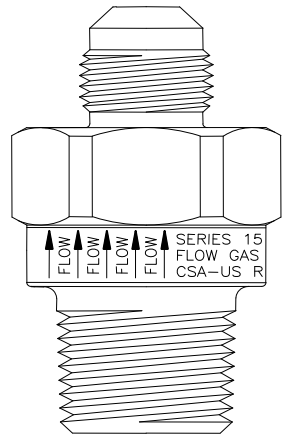

Patents: 6,923,206  
6,488,047 & 5,203,365

MATERIAL SPECIFICATIONS	
<b>Valve Body</b>	C36000 Brass
<b>Magnet</b>	Rare Earth
<b>Plate</b>	Stainless Steel

MATERIAL SPECIFICATIONS	
<b>Seat</b>	C36000 Brass
<b>Cartridge Body</b>	POM

FLOW CAPACITY*						
Model No.	Cartridge	Label Color	Minimum Flow Rate (BTU's at 0.5" W.C.)	Maximum Flow Rate (BTU's at 0.5" W.C.)	Closing Flow Rate (BTU's at 0.6" W.C.)	Bypass Flow Rate
EU2-6-8 P	1540	Lilac	-----	48,000	95,000	< 5 SCFH
EU2-6-12 P	1540	Lilac	-----	48,000	95,000	< 5 SCFH
EU2-8L P	1540	Lilac	-----	60,500	95,000	< 5 SCFH
EU2-8-12L P	1540	Lilac	-----	60,500	95,000	< 5 SCFH
EU2-8 P	1550	Lime	60,501	102,000	135,000**	< 5 SCFH
EU2-8-12 P	1550	Lime	60,501	102,000	135,000**	< 5 SCFH

\*All Safety+PLUS valves require a minimum inlet pressure of 4" W.C. Flow rates given are 0.6 specific gravity natural gas with an average heating value of 1,000 Btu per cubic foot; therefore, 1 kBtu/h is equal to 1 SCFH (standard cubic foot per hour).

\*\*When installed in the vertical downward position (arrows pointing toward floor), the closing flow rate is 110,000 Btu/h.

This specification and all information contained herein is the confidential and exclusive property of BrassCraft Manufacturing, and shall not be disclosed to others without the written consent of BrassCraft. This specification must be returned to BrassCraft if requested.

**BrassCraft®**

# EU2 Series Safety+PLUS® Appliance Excess Flow Valve - Flare x Male Iron Pipe

## Part Listing:

<input type="checkbox"/>	EU2-6-8 P	3/8" O.D. Flare x 1/2" M.I.P., Series 1540 Cartridge, polybagged
<input type="checkbox"/>	EU2-6-12 P	3/8" O.D. Flare x 3/4" M.I.P. (tapped 1/2" F.I.P.), Series 1540 Cartridge, polybagged
<input type="checkbox"/>	EU2-8 P	1/2" O.D. Flare x 1/2" M.I.P., Series 1550 Cartridge, polybagged
<input type="checkbox"/>	EU2-8L P	1/2" O.D. Flare x 1/2" M.I.P., Series 1540 Cartridge, polybagged
<input type="checkbox"/>	EU2-8-12 P	1/2" O.D. Flare x 3/4" M.I.P. (tapped 1/2" F.I.P.), Series 1550 Cartridge, polybagged
<input type="checkbox"/>	EU2-8-12L P	1/2" O.D. Flare x 3/4" M.I.P. (tapped 1/2" F.I.P.), Series 1540 Cartridge, polybagged

PART DIMENSIONS (Inches)			
Model	DIA. A	DIM. B	HEX. C
EU2-6-8	.312	2.19	1-1/8
EU2-6-12	.312	2.19	1-1/8
EU2-8	.438	2.30	1-1/8
EU2-8-12	.438	2.30	1-1/8

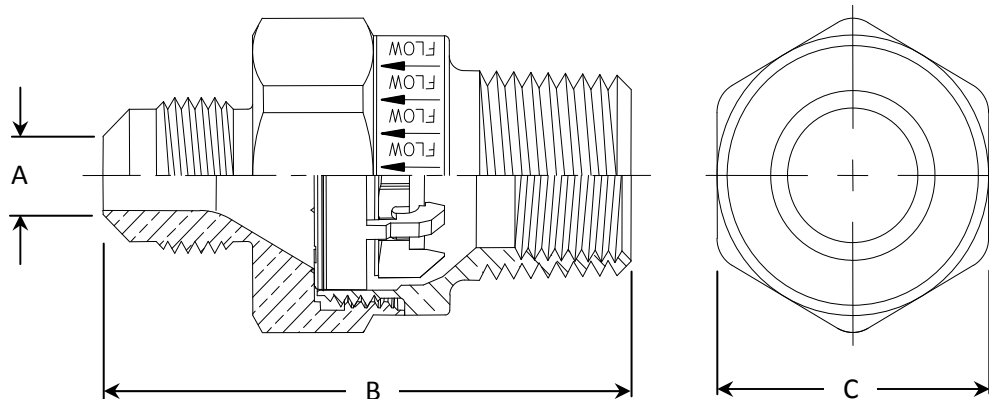

## Listings & Certifications:

- IAPMO listed to CSA-US 3.92 standard "Excess Flow Valves" (file #4213)
- CSA listed to CSA-US 3.92 standard "Excess Flow Valves" (file # 204593)
- California Division of State Architects listed to CSA-US 3.92 standard "Excess Flow Valves" (file# CA-DSA 02 02)
- City of Los Angeles



This specification and all information contained herein is the confidential and exclusive property of BrassCraft Manufacturing, and shall not be disclosed to others without the written consent of BrassCraft. This specification must be returned to BrassCraft if requested.

**BrassCraft®**