

MODELS 1447 & 1448 STAINLESS STEEL RECESSED MOUNTED MEDICINE CABINETS

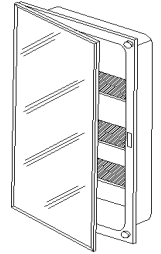

Standard builder models - for recess installation -
Frameless beveled mirror swing door

FEATURES

- Recessed installation for standard wall openings
- Easy to clean, high luster, stainless steel
- Beveled edge glass mirror
- Rust resistant
- Stainless steel piano hinge
- Adjustable glass shelves (1447 - 2 ea / 1448 - 3 ea)
- Reversible for left-hand or right-hand door opening
- Includes mounting hardware

TYPICAL SPECIFICATION

Recessed medicine cabinet shall be of one-piece, stainless steel construction.

Cabinet shall have stainless steel piano hinge and a magnetic door catch.

Each cabinet shall include two, or more, adjustable glass shelves.

Cabinet shall be reversible for left-hand or right-hand installation.

Glass mirror shall have 1/2" bevel on all sides.

MODEL NO.	WALL OPENING			OVERALL SIZE		
	A	B	C	D	E	
1447	14	18	3-1/2	16	20	4-1/2
1448	14	24	3-1/2	16	26	4-1/2

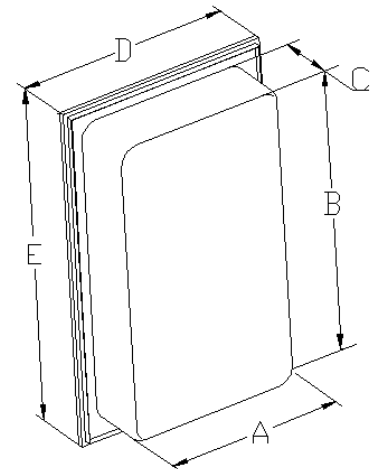

Broan-NuTone Storage Solutions LLC, 501 S. Wilhite Street, Cleburne, TX 76031 (1-800-325-8351)

REFERENCE	QTY.	REMARKS	Project
			Location
			Architect
			Engineer
			Contractor
			Submitted by Date