

PFMM500SWA

1/2" Copper Sweat Male Water Hammer Arrestor



Product Features

- For single fixture residential use.
- Helps to eliminate shock waves generated in piping systems by sudden on/off changes in flow.
- Brass piston.

Product Specifications

Connection Size: 1/2" Copper Male Sweat
Temperature Range: 33°F to 180°F
Maximum Pressure: 600psi
ASSE 1010-2004
IAMPO Listed (cUPC)

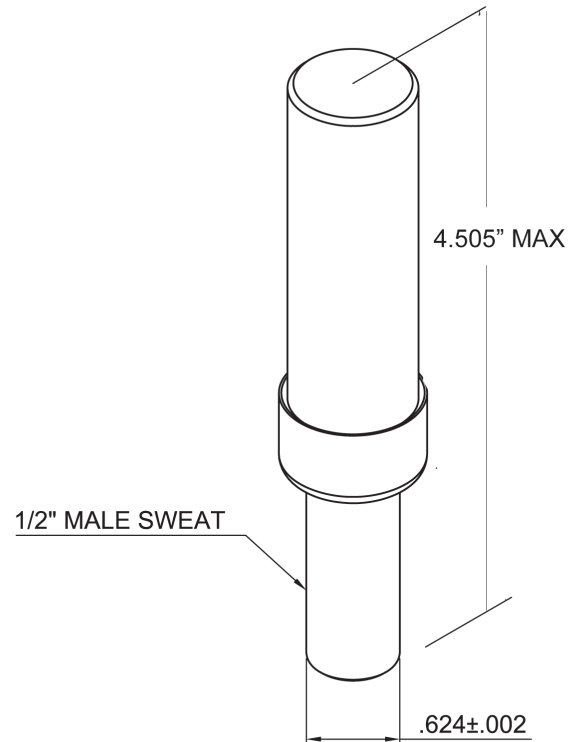

Warranty and Codes

This PROFLO product carries a 1-year limited warranty

