

Application

Designed for installation on water lines to protect against backsiphonage of contaminated water into the potable water supply. Assembly shall provide protection where a potential health hazard exists.

Standards Compliance

- ASSE® Listed 1001
- CSA® Certified
- IAPMO® Listed

Materials

Main valve body	Cast Brass (1/4"-1/2") Cast Bronze ASTM B 584 (3/4"-2")
Elastomers	Silicone (FDA approved) Buna Nitrile (FDA approved)
Polymers	ULTEM™, NSF Listed (1/4"-1/2") Polypropylene (3/4"-2")



Model 35CH (1/2")



Model 35VCH (1/4")



Model 35 (3/4" - 2")

Options

(Suffixes can be combined)

- ☐ CH - with rough chrome plate finish (1/2" only)
- ☐ VCH - with vertical inlet and outlet with rough chrome finish (1/4" only)

Accessories

- ☐ SXL - Bronze Wye Strainer

Features

Sizes: 1/4, 1/2", 3/4", 1", 1 1/4", 1 1/2", 2"

Maximum working water pressure 125 PSI

Maximum working water temperature 180°F

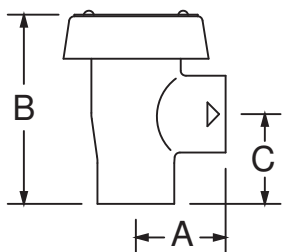

35 (1/2")

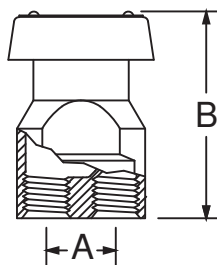

35VCH (1/4")

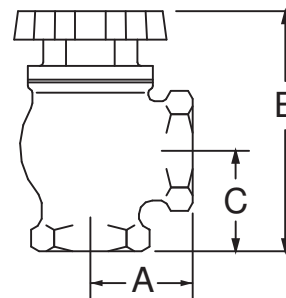

35 (3/4" - 2")

Dimensions (do not include pkg.)

MODEL SIZE		DIMENSIONS (approximate)						WEIGHT	
		A		B		C			
in.	mm	in.	mm	in.	mm	in.	mm	lbs.	kg
1/4 VCH	8	3/4	19	2 3/8	60	N/A	N/A	1	0.5
1/2	15	1 5/16	33	2 1/2	64	1 1/4	32	2	0.9
3/4	20	1 1/2	38	2 15/16	75	1 1/2	38	2	0.9
1	25	1 5/8	41	2 5/16	51	1 1/2	38	2	0.9
1 1/4	32	2	51	4 1/2	114	2	51	3	1.4
1 1/2	40	2 1/4	57	4 7/8	124	2 1/16	52	4	1.8
2	50	2 3/4	70	5 9/16	141	2 1/2	64	6	2.7

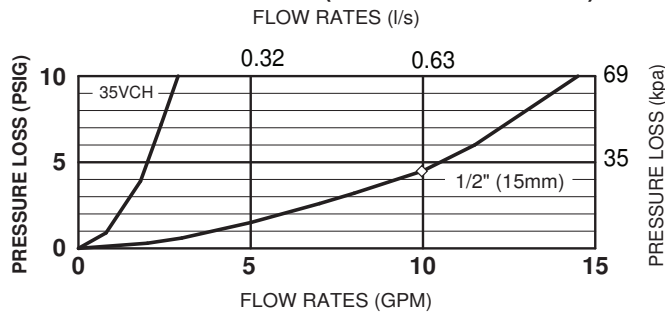
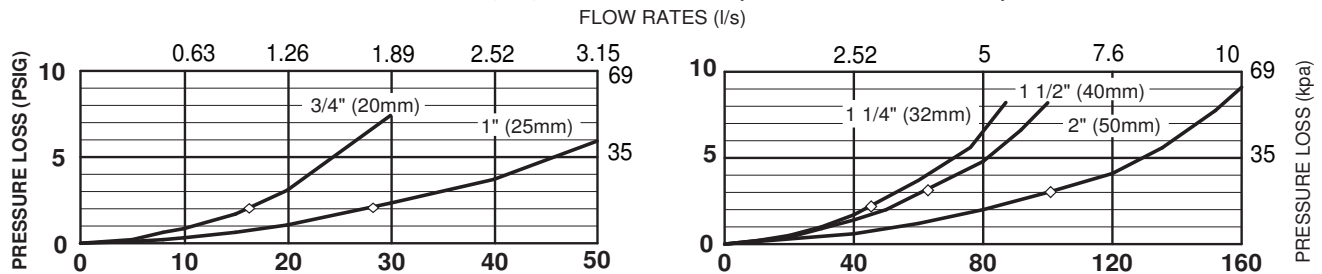
MODEL 35 1/4" & 1/2"(STANDARD & METRIC)**MODEL 35 3/4", 1", 1 1/4" 1 1/2" & 2"(STANDARD & METRIC)****Typical Installation**

Local codes shall govern installation requirements. To be installed in accordance with the manufacturer's instructions and the latest edition of the Uniform Plumbing Code. Unless otherwise specified, the assembly shall be mounted at a minimum of 6" (150mm) above the highest point of discharge with sufficient side clearance for maintenance. Because the Model 35 is not to be used under continuous pressure never place a shut-off or check valve downstream of the device. The installation shall be made so that no part of the unit can be submerged.

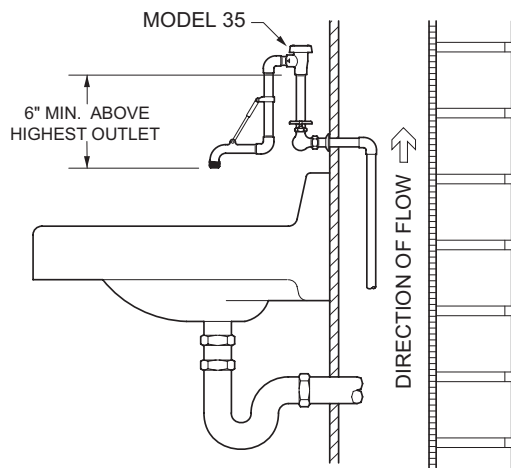
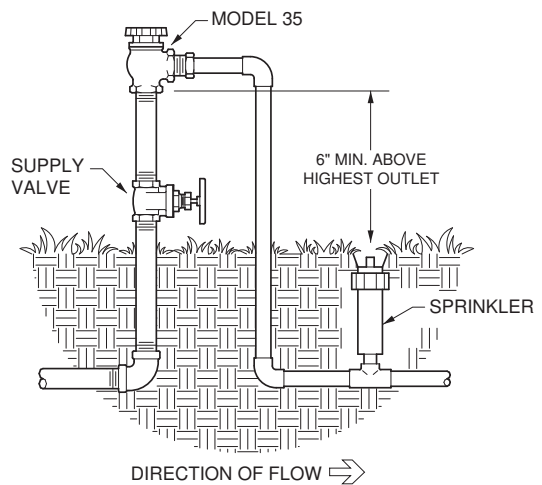
**MODEL 35 INSTALLATION****MODEL 35 INSTALLATION****Specifications**

The Atmospheric Vacuum Breaker shall be ASSE® Listed 1001. The main body shall be cast bronze (3/4"-2"), and cast brass (1/4"-1/2"). All internal polymers shall be NSF® Listed ULTEM™ or Polypropylene and the seat disc elastomers shall be Silicone. The device shall be accessible for maintenance without removing the device from the service line. The installation shall not be in a concealed or inaccessible location, or where the venting of water from the device, during normal functioning, may be deemed objectionable. The Atmospheric Vacuum Breaker shall be a ZURN WILKINS Model 35 or Model 35VCH.