

Figure 1201 PRESSURE REDUCING VALVES

FNW™

STANDARD CAPACITY WATER PRV BRASS w/FEMALE UNION INLET

The FNW figure 1201 water pressure reducing valves are designed to reduce incoming water pressure to an appropriate, safe level. Reduced water pressure decreases water consumption and protects plumbing system components. The 1201 is suitable for water supply pressures up to 300 PSI (2,068 kPa) with an adjustable output of 25 to 75 PSI (172 to 517 kPa). The setting from the factory is 50 PSI (345 kPa). Components are serviceable while the valve is in-line, including the integral stainless steel strainer. When downstream pressure exceeds inlet pressure due to thermal expansion, the built-in by-pass permits water flow back through the valve to the main.

Features:

- Max. Working Pressure: 300 PSI
- Max. Working Water Temperature: 160°F
- Adjustable Reduced Pressure Range: 25 - 75 PSI
- Factory Preset: 50 PSI
- Built-in By-pass for Thermal Expansion Control
- Internal High-capacity Stainless Steel Strainer
- Replaceable Stainless Steel Seat
- High-temperature Resistant Diaphragm
- In-line Serviceable
- Threaded Female Union Inlet with Gasket
- Concealed Diaphragm
- Corrosion Resistant Adjustment Hardware

Standards:

- ASSE Standard 1003 (ANSI A112.26.2)
- CSA Standard B356
- IAPMO Listed (UPC)
- ANSI/NSF61-8

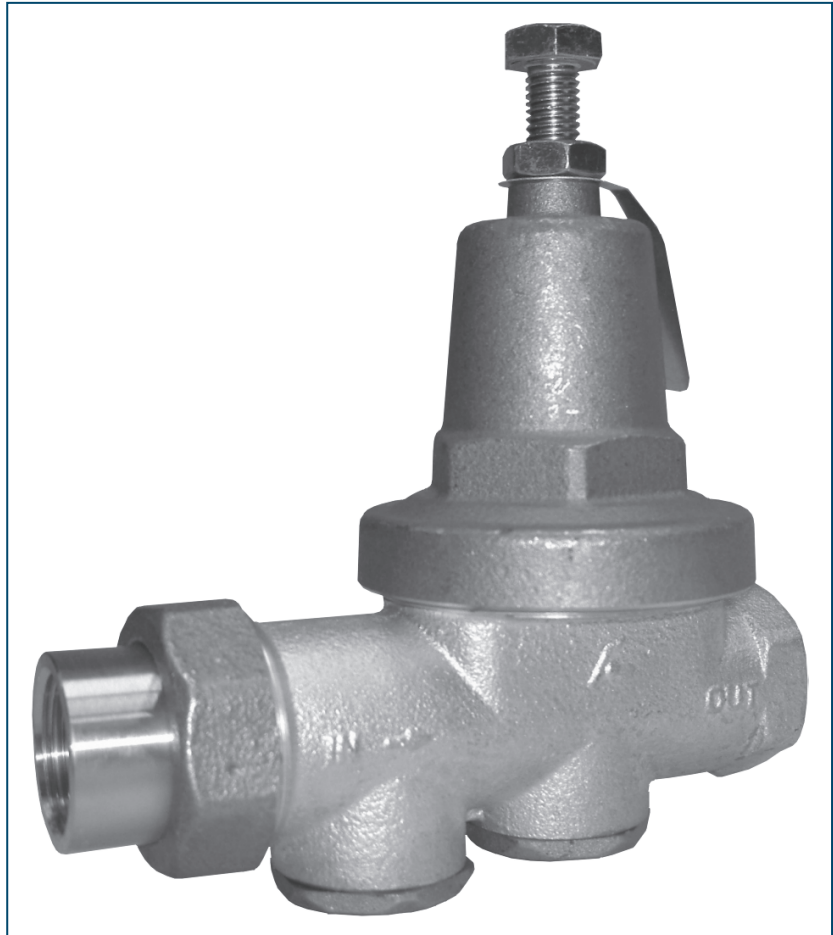

Figure Number Matrix

FNW 1201 Size

SIZE CODE

1/2 = D

3/4 = F

1 = G

STANDARD CAPACITY WATER PRV BRASS w/FEMALE UNION INLET

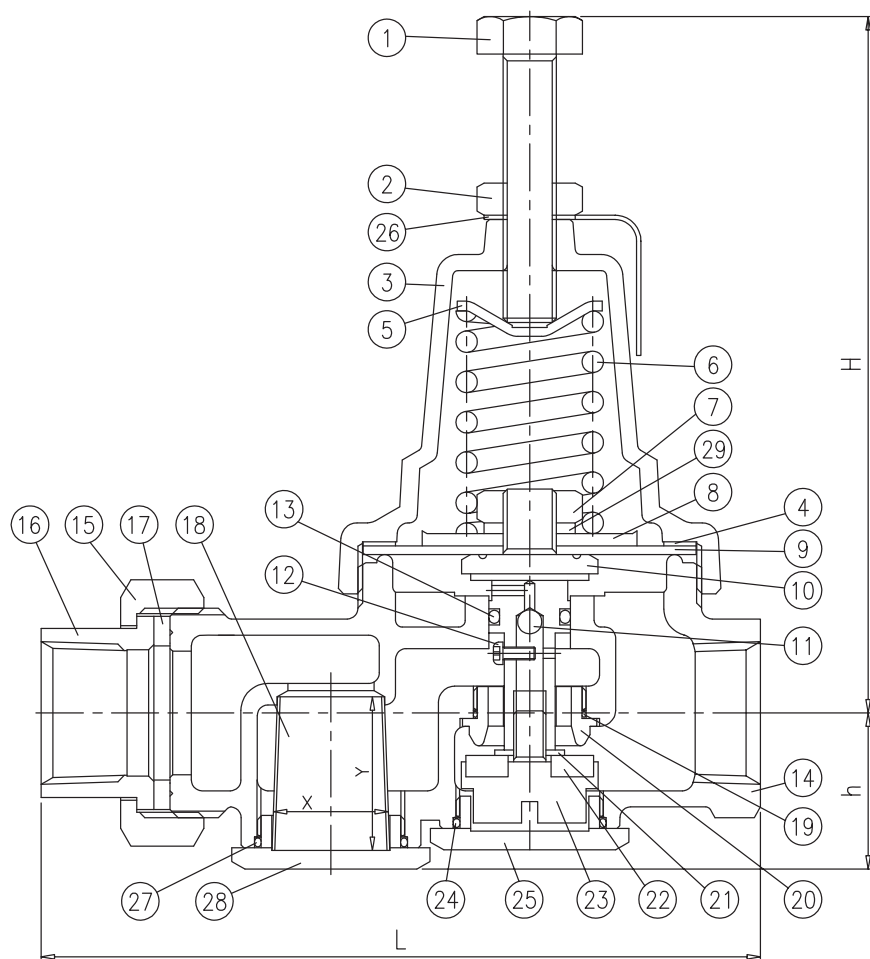

Standard Materials

No.	Description	Material
1	Adjustment Bolt	Steel A283-D
2	Lock Nut	Steel AISI-1010
3	Bonnet	Brass B584-C85700
4	Friction Ring	Steel A283-D
5	Spring Disc	Steel A283-D
6	Spring	ASTM A227/A227M-91
7	Diaphragm Nut	Steel AISI-1010
8	Diaphragm Disc	Steel A283-D
9	Diaphragm	BUNA-N+NYLON
10	Stem	Brass B16-C36000
11	Rubber Ball	BUNA-N
12	Ball Screw	Stainless SUS304
13	Stem O-ring	BUNA-N
14	Body	Brass B584-C83600
15	Union Nut	Brass B584-C85700
16	Union	Brass B124-C37700
17	Union Gasket	NBR
18	Strainer	Stainless SUS304
19	Seat O-ring	BUNA-N
20	Seat	Stainless SUS304
21	Plunger Washer	Stainless SUS304
22	Plunger Seal	BUNA-N
23	Plunger	Brass B16-C36000
24	Cap O-ring	BUNA-N
25	Cap	Brass B124-C37700
26	Name Plate	Aluminum B209-1100
27	Strainer Cap O-ring	BUNA-N
28	Strainer Cap	Brass B124-C37700
29	Spring Washer	ASTM A227/A227M-91

Capacity

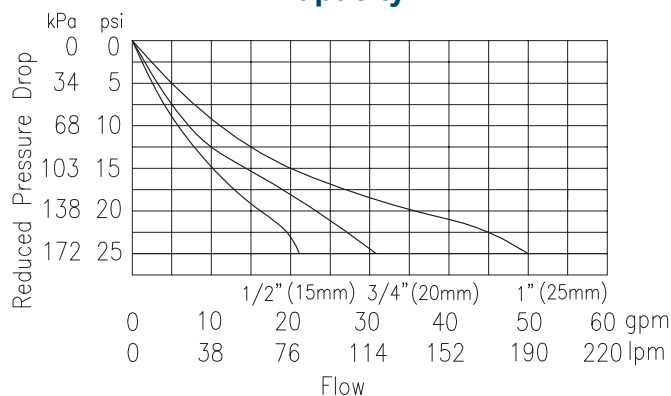

Dimensions (inches)

Size	L	H	h	Strainer Info.			Wt. (lbs.)
				X	Y	Mesh	
1/2	5.28	5.12	1.14	1.18	0.87	24	3.03
3/4	5.28	5.12	1.14	1.18	0.87	24	2.99
1	6.26	5.71	1.54	1.50	1.02	20	4.72