

BI-36RG/O



FEATURES

- Monitor and control remotely with Wi-Fi connectivity
- Accepts custom panels for an integrated look within cabinetry or stainless-steel accessory panels and handles to match other Sub-Zero, Wolf, and Cove products
- Fight spoilage and odors with a NASA-inspired air purification system
- Locks in cold air to ensure freshness with magnetic door seals
- Keeps produce fresher with high-humidity, sealed crisper and deli drawers
- Controls temperature within one degree of setpoint
- Display food via a single, triple-pane and UV-resistant glass door
- Ensures excellent visibility with bright lights
- Refer to freshness cards for tips on food preservation, use, and care

ACCESSORIES

- 66" Dual Flush Inset Stainless Grille Panel
- 90° Door Stop
- Air Purification Cartridge
- Custom Side Panel Mounting Kit
- Dual Installation Kit
- Egg Container
- Extended Framed Handle Kit
- Framed Handle
- Framed Louvered Grille Insert
- Grille Frame - 83"
- Grille Frame - 88"
- Louvered Grille - 83"
- Louvered Grille - 88"
- Pro Louvered Flush Inset Grille - 84"
- Stainless Steel Dual Flush Inset Door Panel with Pro Handle - LH
- Stainless Steel Dual Flush Inset Door Panel with Pro Handle - RH
- Stainless Steel Dual Flush Inset Door Panel with Tubular Handle - LH
- Stainless Steel Dual Flush Inset Door Panel with Tubular Handle - RH
- Stainless Steel Dual Flush Inset Grille Panel
- Stainless Steel Flush Inset Door Panel with Pro Handle - Left Hinge
- Stainless Steel Flush Inset Door Panel with Pro Handle - Right Hinge
- Stainless Steel Flush Inset Door Panel with Tubular Handle - Left Hinge
- Stainless Steel Flush Inset Door Panel with Tubular Handle - Right Hinge
- Stainless Steel Flush Inset Grille Panel
- Stainless Steel Kickplate - Left Hinge



HANDLE ACCESSORIES

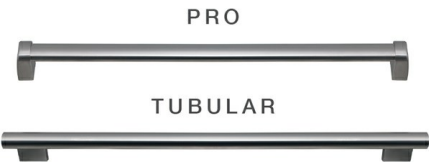

PRODUCT DETAILS

REFRIGERATOR

- LED refrigerator lights
- 4 glass refrigerator shelves (3 adjustable; 1 stationary)
- 1 high-humidity crisper drawer with adjustable dividers
- 2 storage drawers with adjustable dividers
- 1 adjustable dairy compartment

Stainless Steel Kickplate - Right Hinge

Stainless Steel Side Panel

White Side Panel

Dual Installation Kit with Dual Wide Grille

Accessories are available through an authorized dealer.  
For local dealer information, visit [subzero-wolf.com/locator](http://subzero-wolf.com/locator).

Specifications are subject to change without notice. This information was generated on March 2, 2020. Verify specifications prior to finalizing your cabinetry/enclosures.

## PRODUCT SPECIFICATIONS

Model	BI-36RG/O
Dimensions	36"W x 84"H x 24"D
Door Clearance	37 1/4"
Weight	430 lbs
Refrigerator Capacity	23.3 cu. ft.
Electrical Supply	115 VAC, 60 Hz
Electrical Service	15 amp dedicated circuit
Receptacle	3-prong grounding-type

## ELECTRICAL

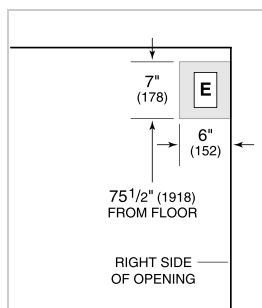

**PANEL SPECIFICATIONS** For complete panels specifications including width/height, weight requirements, thickness requirements and offset details visit [subzero-wolf.com/builtinconfigurator](http://subzero-wolf.com/builtinconfigurator).

**NOTE:** Dimensions in parenthesis are in millimeters unless otherwise specified

## INTERIOR VIEW



This illustration is intended for interior reference only and may not represent the exterior of the model being specified.

## DIMENSIONS

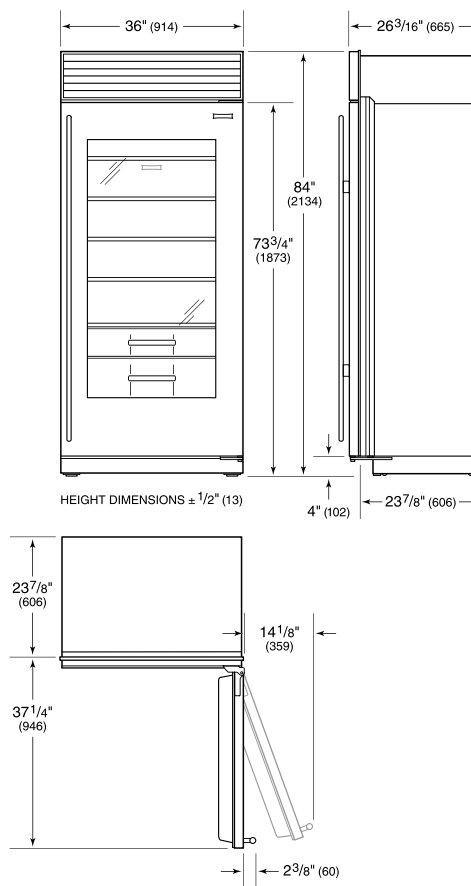

## FLUSH INSET INSTALLATION

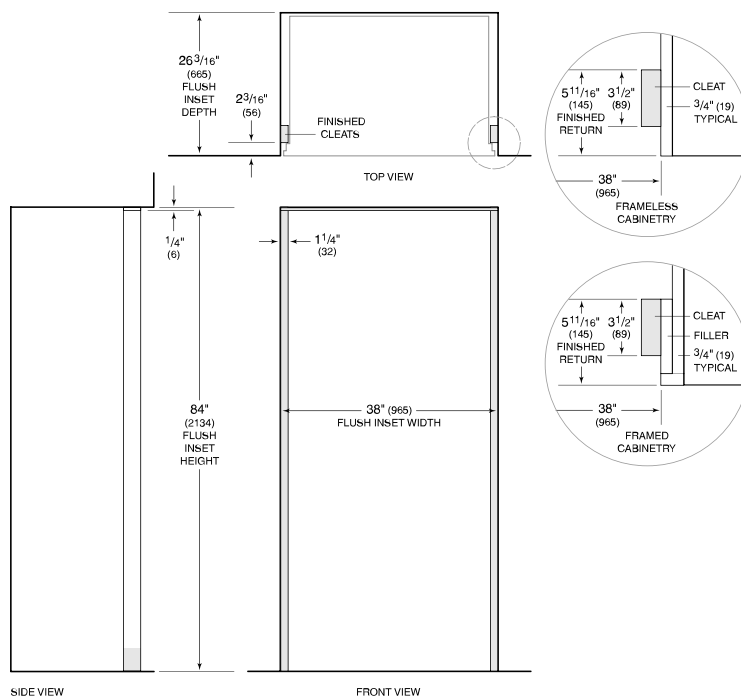

**NOTE:** 3 1/2" (89) finished returns and shaded areas will be visible and should be finished to match cabinetry. Shaded line represents profile of unit with 3/4" (19) panel.