

# True professional style and performance has never been easier to bring home.

- Brushed stainless steel finish.
- Bright halogen lighting with two settings; Two 50-watt bulbs in 30" and 36" widths, Three 50-watt bulbs in 42" and 48" widths (purchase bulbs separately).
- Pro-style, dishwasher-safe baffle filters with removable grease drip rail.
- Variable speed control remembers last setting—blue power-on indicator light.
- Heat Sentry™ detects excessive heat and adjusts blower speed automatically.
- Designed to duct out of the hood shell in either horizontal or vertical direction with any blower configuration.
- Designed to work with Broan Automatic Make-up air damper.



## Internal Blower Specifications

WIDTH	STAINLESS STEEL	CFM	SONES NORMAL SETTING <sup>1</sup>	LAMPS	MAX AMPS <sup>2</sup>	DUCTING <sup>2</sup>
30"	E6030SS	600	1.5	2-50W GU10	5.0	3-1/4" x 10"
36"	E6036SS	600	1.5	2-50W GU10	5.0	3-1/4" x 10"
42"	E6042TSS	1200	2.0	3-50W GU10	9.0	4-1/2" x 18"
48"	E6048TSS	1200	2.0	3-50W GU10	9.0	4-1/2" x 18"

<sup>1</sup> Sones at high speed for Internal 600–13.5 max; Internal 1200–14.5 max.

<sup>2</sup> Duct adapter & damper is included with the Internal blowers.

♦ 120V 60Hz

## External Blower Specifications

WIDTH	STAINLESS STEEL	CFM <sup>1</sup> (see page 43)	SONES <sup>2</sup>	LAMPS	MAX AMPS <sup>3</sup>	DUCTING <sup>3</sup>
30"	E60E30SS	280–1500	see below	2-50W GU10	5.5	10" Rd
36"	E60E36SS	280–1500	see below	2-50W GU10	5.5	10" Rd
42"	E60E42SS	280–1500	see below	3-50W GU10	6.0	10" Rd
48"	E60E48SS	280–1500	see below	3-50W GU10	6.0	10" Rd

<sup>1</sup> See page 43 for Exterior (600–1500 CFM) and Inline (280–1100 CFM) blower specifications.

<sup>2</sup> Sone levels are typically half of comparable CFM internal blowers.

<sup>3</sup> External blower capable models include the 332KR rough-in kit (Purchase blowers separately).

♦ 120V 60Hz

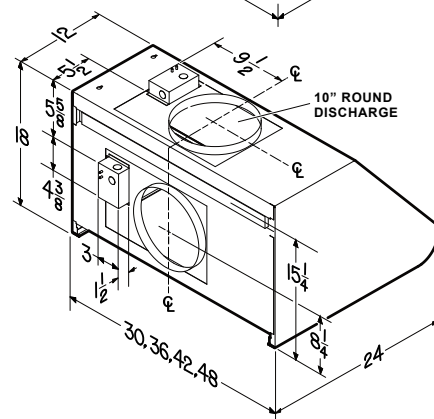
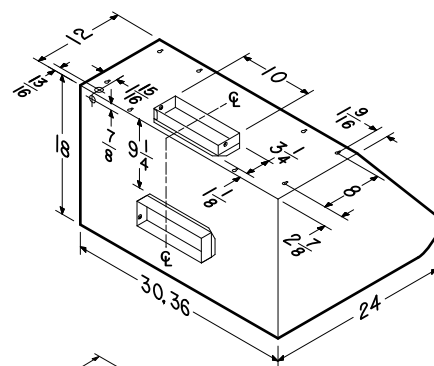

Pro-style, dishwasher-safe baffle filters with removable grease drip rail. Filters feature handles for convenient removal.



A non-duct kit may be used to recirculate filtered air back into the kitchen if ducting is not practical.



The professional look is completed with an optional backplash.

## E60000 Optional Accessories Selection Table

WIDTH	NON-DUCT KIT <sup>†</sup>	12" SOFFIT FLUE COVER	BACKSPLASH	NON-DUCTED FILTER*	MAKE-UP AIR DAMPER
30"	ANKE60302SS	AEE60302SS	RMP3004	ROUNDFILTER	MD6T, MD8T
36"	ANKE60362SS	AEE60362SS	RMP3604	ROUNDFILTER	MD6T, MD8T
42"	ANKE60422SS	AEE60422SS	RMP4204	ROUNDFILTER**	MD6T, MD8T
48"	ANKE60482SS	AEE60482SS	RMP4804	ROUNDFILTER**	MD6T, MD8T

<sup>†</sup> For models with internal blowers only.

\* Includes non-ducted filters.

\*\* Requires two packs for 1200 CFM Blower.

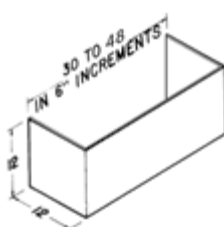

12" SOFFIT FLUE COVER

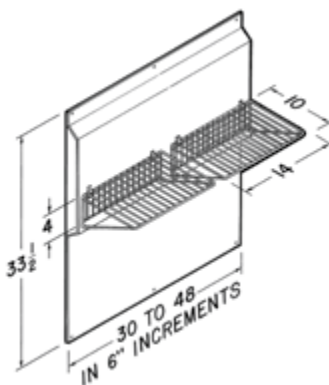

Make-Up Air Damper Model MD6T, MD8T