

Features

- Brass construction.
- Dual control wall-mounted.
- Includes valve.
- Oval handles.
- 1.5 gal/min (5.7 l/min) maximum flow rate [max at 60 psi (4.14 bar)].

Optional Accessories

- K- 7107 Decorative Drain
- K- 7108 Decorative Drain
- K- 7114 Pop-Up Drain
- K- 7124 Pop-Up Clicker Drain
- K- 7127 Drain
- K- 7129 Drain



Codes/Standards

ASME A112.18.1/CSA B125.1

NSF 61

NSF 372

DOE - Energy Policy Act 1992

EPA WaterSense®

All applicable US Federal and State material regulations

KOHLER® Faucet Lifetime Limited Warranty

See website for detailed warranty information.

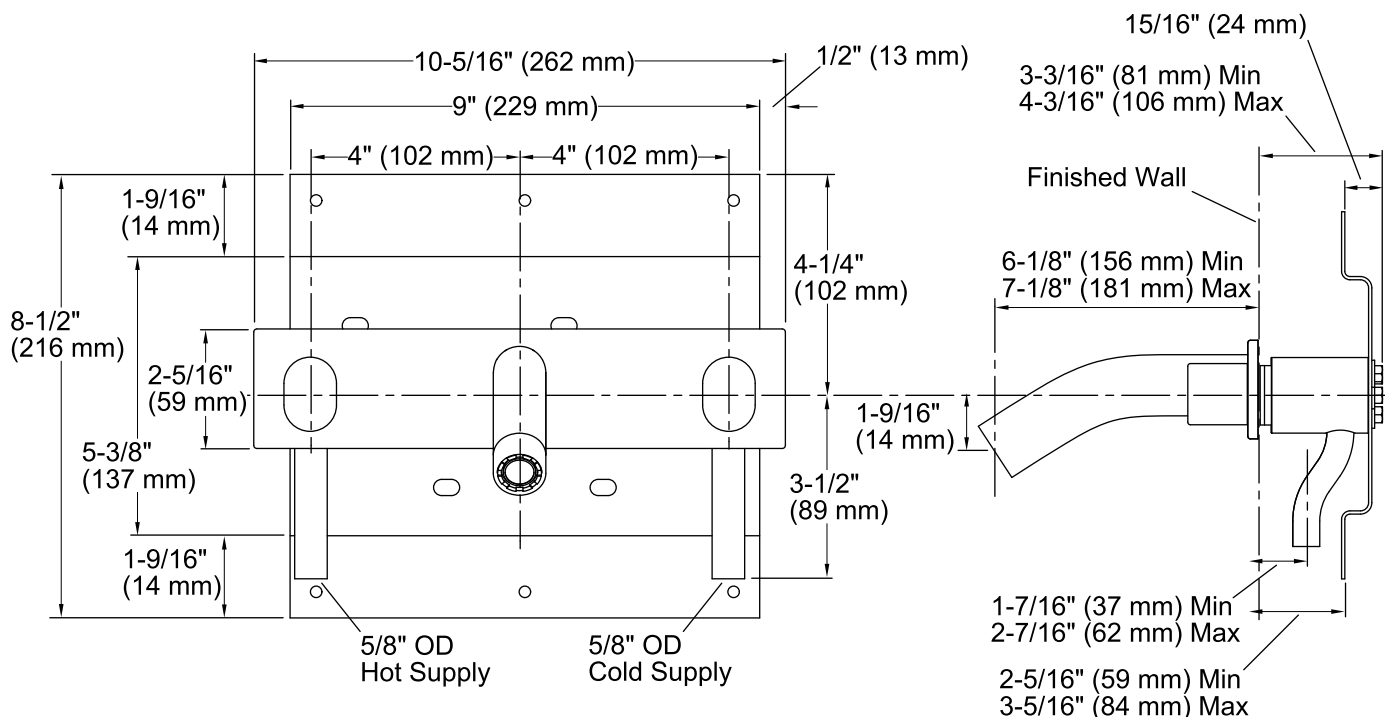

Technical Information

All product dimensions are nominal.

Faucet:

Flow rate: 1.5 gal/min (5.7 l/min)

Pressure: 60 psi (4.1 bar)

Notes

Install this product according to the installation guide.

Three Ø1-1/8" (29 mm) diameter holes are required for the spout and handles.

1-1/2" (38 mm) minimum must be maintained between bottom of spout and top of fixture rim.