



**Persuade®**

Vanity  
**K-2529**

### Features

- One door and one pullout drawer with two storage trays.
- Combines with the K-2956 Persuade sink for a complete vanity.
- Coordinates with other products in the Persuade Ensemble.

### Material

- Durable melamine surface on interior and exterior.

### Recommended Accessories

K- 2956-1 Vanity-top Bathroom Sink.

K- 2956-4 Vanity-top Bathroom Sink

K- 2956-8 Vanity-top Bathroom Sink



### Codes/Standards

CARB P2

### KOHLER® One-Year Limited Warranty

See website for detailed warranty information.

### Available Color/Finishes

*Color tiles intended for reference only.*

Color	Code	Description
-------	------	-------------

	F65	Mantle
--	-----	--------

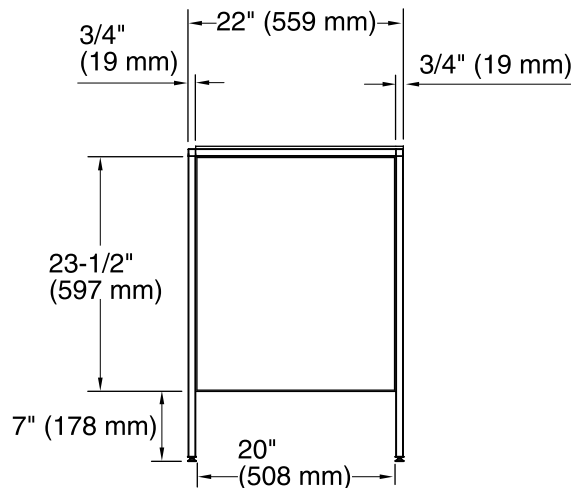
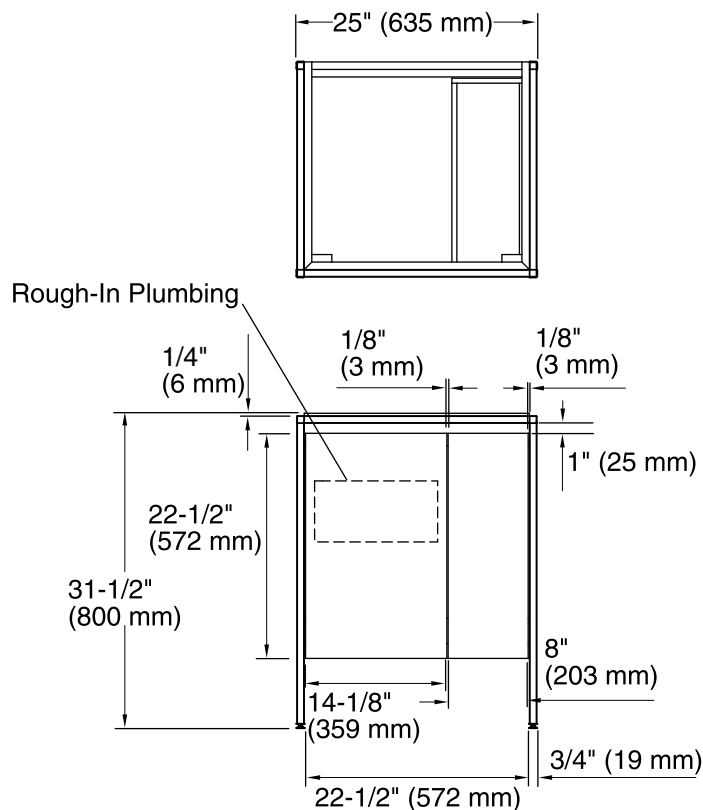

### Technical Information

All product dimensions are nominal.

### Notes

Install this product according to the installation guide.

NOTE: The K-2956 Persuade bathroom sink is recommended for this vanity. Do not select an under-mount Caxton® model for this vanity, as it is not designed for this vanity.

WARNING: Risk of property damage. Select 250 lbs (113.4 kg) load bearing lag bolts with a length that can safely clear any obstacles in the wall. Calculate the proper length of the lag bolts by adding the following: 1-1/2" (38 mm) bracing + wall board thickness + bracket thickness.

NOTICE: If a bathroom sink will be installed, the plumbing must be roughed into the plumbing cutout area of the vanity. Refer to the bathroom sink roughing-in and the vanity roughing-in for proper placement. The water supply and drain lines must be installed before installing the vanity.