

Figure 220ASE STAINLESS STEEL BALL VALVES



2 PC FULL PORT 150 PSI SAFETY EXHAUST VALVE

The figure 220ASE is an ideal safety option for compressed air applications with downstream pneumatic equipment. Conventional shut off valves can trap compressed air in pneumatic equipment, creating a potentially dangerous situation. With the 220ASE safety exhaust valve, down stream pressure is vented through the body when the valve is in the closed position. The full port design minimizes pressure drop and the all stainless steel construction provides robust corrosion resistance.

Features:

- 150 PSI Max. Pressure
- Full Port
- Blow-out Proof Stem
- Adjustable Packing
- Investment Cast Body
- TFM (Super TFE) Seats
- Threaded NPT Ends
- Stainless Steel Handle
- Locking Lever
- Tapped Hole Mounting Pad for Actuation or Panel Mount Applications
- Non-Vented Ball
- Installation Arrow (Ensures proper installation by indicating downstream direction)

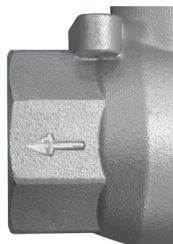

Standards:

- General Design: ASME B16.34, MSS SP-110
- End Connections: ASME B1.20.1

Figure Number Matrix

FNW 220A SE		Size
SIZE CODE		
1/4 = B		1 = G
3/8 = C		1-1/4 = H
1/2 = D		1-1/2 = J
3/4 = F		2 = K



Design Principle

When the valve is in the open position, air from the compressor is delivered down stream to pneumatic equipment.

The bypass on the ball is not engaged, and seat compression minimizes any air loss through the body.

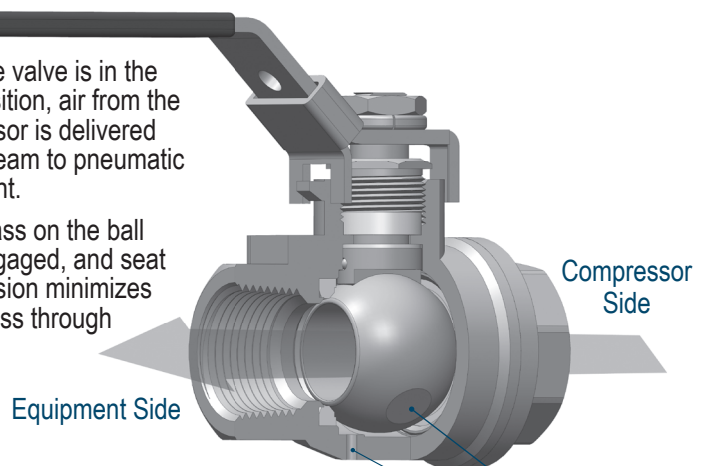

When the valve is in the closed position, the compressor side is blocked off. The down stream equipment side is allowed to flow back past the bypass and out the vent.

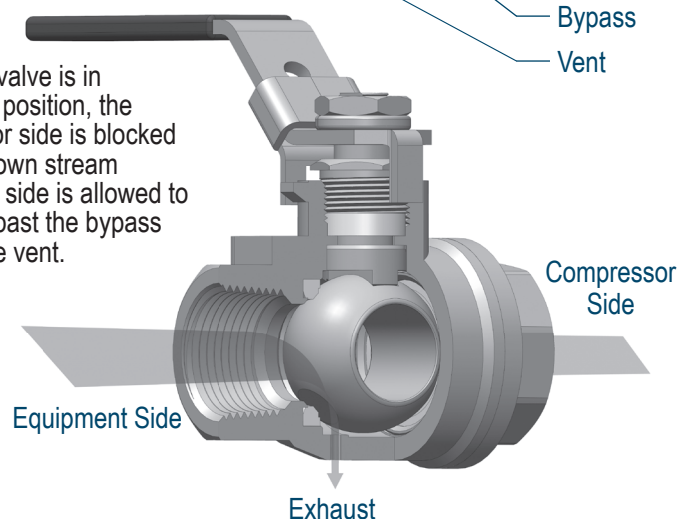

2 PC FULL PORT 150 PSI SAFETY EXHAUST VALVE

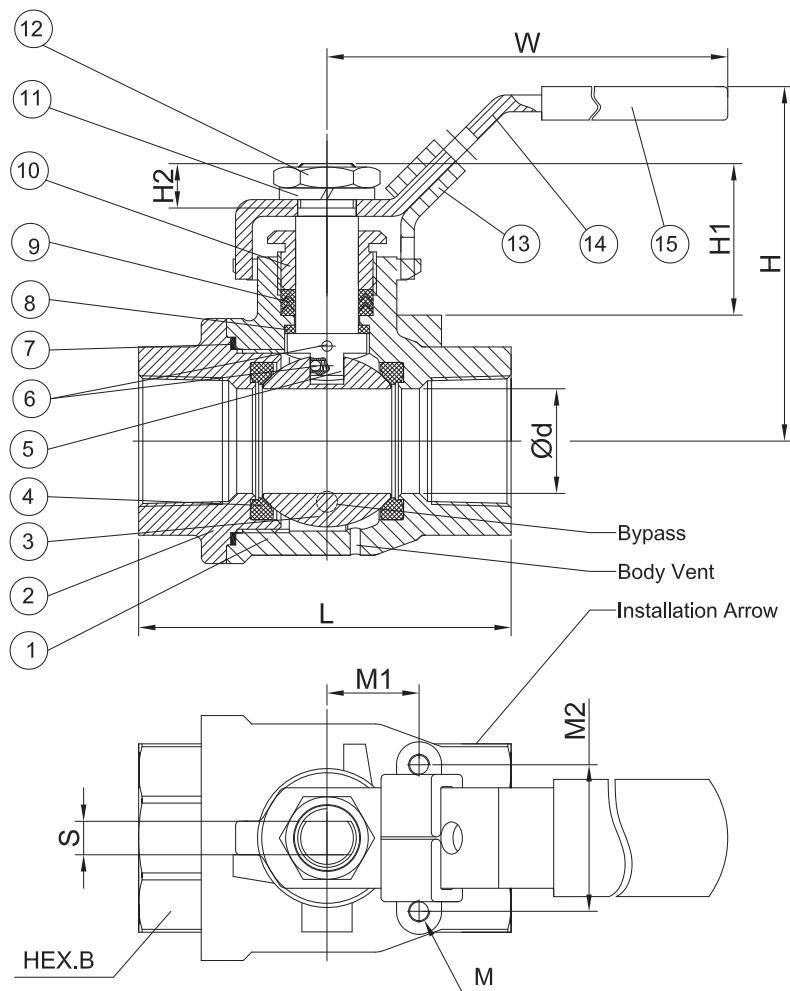

Standard Materials

Ref. No.	Description	Material	Qty
1	Body	ASTM A351 Gr. CF8M Stainless	1
2	End Cap	ASTM A351 Gr. CF8M Stainless	1
3	Ball	316SS Stainless	1
4	Seat	TFM1600+20%GF	2
5	Stem	316SS Stainless	1
6	Anti-Static Device	316SS Stainless	2
7	Body Gasket	PTFE	1
8	Thrust Washer	TFM4215	1
9	V-Ring Packing	PTFE	1 Set
10	Gland Nut	304SS Stainless	1
11	Handle Washer	304SS Stainless	1
12	Handle Nut	304SS Stainless	1
13	Locking Pad	304SS Stainless	1
14	Handle	304SS Stainless	1
15	Handle Cover	Vinyl Plastic	1

Cv, Torque & Weight

Size	Cv	Torque (in-lbs)	Wt (lbs)
1/4	15	69	1.15
3/8	15	69	1.15
1/2	18	77	1.15
3/4	36	98	1.72
1	48	166	1.90
1-1/4	58	277	3.53
1-1/2	120	388	6.00
2	190	582	9.17

Dimensions (inches)

SIZE	Ød	L	H1	H2	H	W	S	M1	M2	M (UNC)	B
1/4	0.42	2.17	1.34	0.40	2.52	3.74	0.314	0.50	1.12	10-24	1.06
3/8	0.50	2.17	1.34	0.40	2.52	3.74	0.314	0.50	1.12	10-24	1.06
1/2	0.59	2.55	1.34	0.40	2.52	4.92	0.314	0.50	1.12	10-24	1.06
3/4	0.79	3.03	1.52	0.43	2.64	4.92	0.314	0.88	1.38	10-24	1.26
1	0.98	3.46	1.46	0.42	3.27	5.51	0.314	0.88	1.38	10-24	1.61
1-1/4	1.26	4.01	2.09	0.83	3.50	5.51	0.314	1.00	1.50	1/4-20	1.97
1-1/2	1.50	4.33	2.44	1.12	3.93	7.87	0.472	1.00	1.50	1/4-20	2.20
2	1.97	4.92	2.36	1.09	4.25	7.87	0.472	1.00	1.50	1/4-20	2.76

