

## Features

- Metal construction.
- Intended for use with Rite-Temp® or HiFlow Rite-Temp® valves.
- Lever handle.
- Includes showerhead with arm and flange, 4-7/8" (124 mm) diverter spout with 1/2" -14 NPT connection, and faceplate with handle.
- 2.0 gal/min (7.6 l/min) maximum flow rate showerhead with Katalyst™ Spray Technology.

## Required Accessories

K- 2971-KS 3/4" Pressure-balancing Valve

or

K- 304-CS Pressure-balancing Valve With Stops

or

K- 304-CX Pressure-balancing Valve Less Stops

or

K- 304-K Pressure-balancing Valve Less Stops

or

K- 304-KS Pressure-balancing Valve With Stops

or

K- 304-PS Pressure-balancing Valve With Stops

or

K- 304-PX Pressure-balancing Valve Less Steps

or

K- 304-US Pressure-balancing Valve With Stops

or

K- 304-UX Pressure-balancing Valve Less Stops

## Optional Accessories

88526 Thin Wall Trim Kit



## Codes/Standards

ASME A112.18.1/CSA B125.1

ASSE 1016

DOE - Energy Policy Act 1992

## KOHLER® Faucet Lifetime Limited Warranty

See website for detailed warranty information.

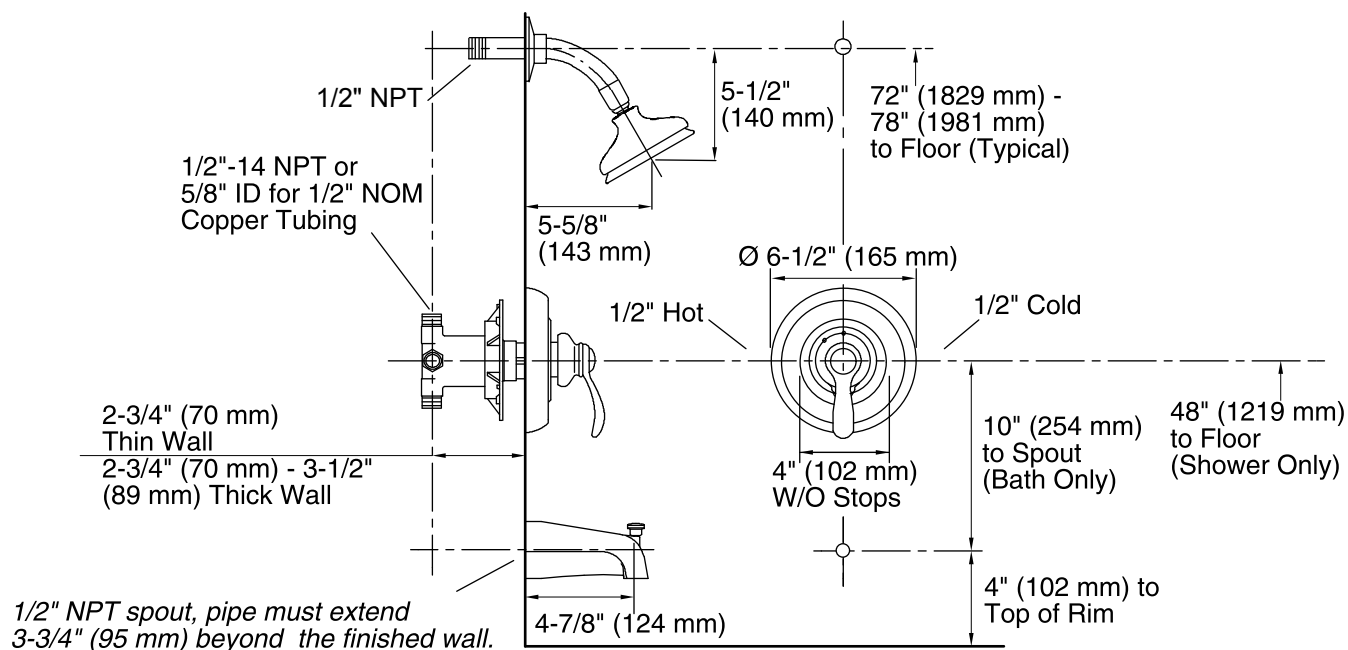

### Technical Information

All product dimensions are nominal.

Spout reach: 4-7/8" (124 mm)

### Showerhead:

Rated maximum flow: 2 gal/min (7.6 l/min)

### Notes

Install this product according to the installation guide.

**NOTICE:** Risk of product damage. Long screws, for installing trim, can damage the K-2971-KS valve. Consult the trim installation guide to verify if the thin wall installation kit (88526) is needed.

Install straight pipe or tube drop of 7" (178 mm) to 18" (457 mm) with single elbow between valve and wall-mount spout.