

# EDENTON

## THERMOSTATIC SHOWER VALVE TRIM

SKU: 948911



### FEATURES

Material: Brass  
Shape: Round  
Handle Type: Lever  
Features: Thermostatic  
Assembly Required: No  
Installation Type: Wall  
Metal Lever Handle  
Temperature Outlet Factory Preset to 104  
Degrees Fahrenheit  
Temperature Can Be Easily Adjusted Up and  
Down to User's Comfort Level  
Scald Guard Protection  
High Temperature Limit Stop  
Thermostatic Technology Keeps Shower  
Temperature Within 1 Degree Celsius  
For Proper Installation, Requires Use of Volume  
Control Valve and Trim  
Optional Rough-In Valve

### CONTENTS

TRIM .....	PAGE 2
VALVE .....	PAGE 3

REVISED 10/05/2020

# EDENTON

## THERMOSTATIC TRIM

SKU: 948911

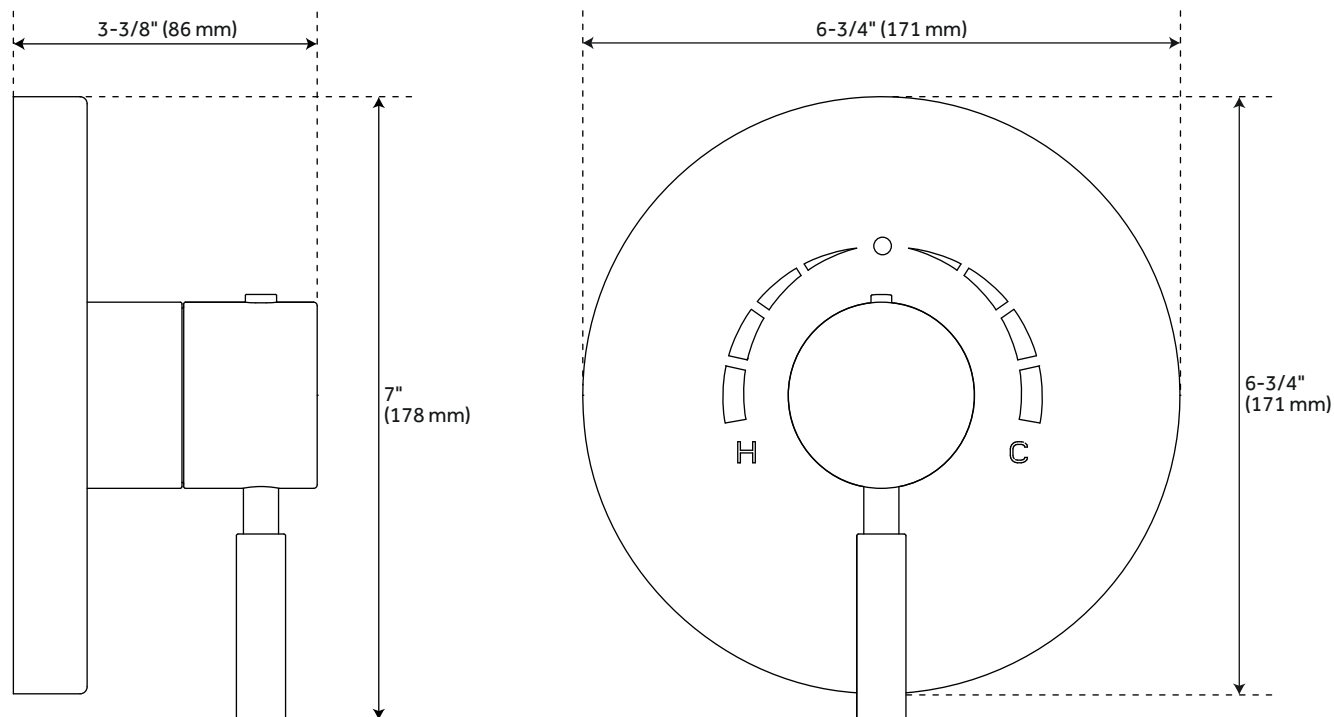

### FEATURES

Width: 6-3/4"  
Height: 6-3/4"  
Depth: 3-3/8"  
Wall Thickness Range: 1" to 1-3/4"

### CODES/STANDARDS

cUPC  
ASME A112.18.1/CSA B125.1  
ADA compliant (when installed  
according to ADA standards)  
Massachusetts Accepted

### PRODUCT IMAGE



All dimensions and specifications are nominal and may vary. Use actual products for accuracy in critical situations.

PAGE 2  
Code: SHED9009

# EDENTON

## OPTIONAL THERMOSTATIC VALVE WITH 1/2" -OR- 3/4" CONNECTION

SKU: 948911

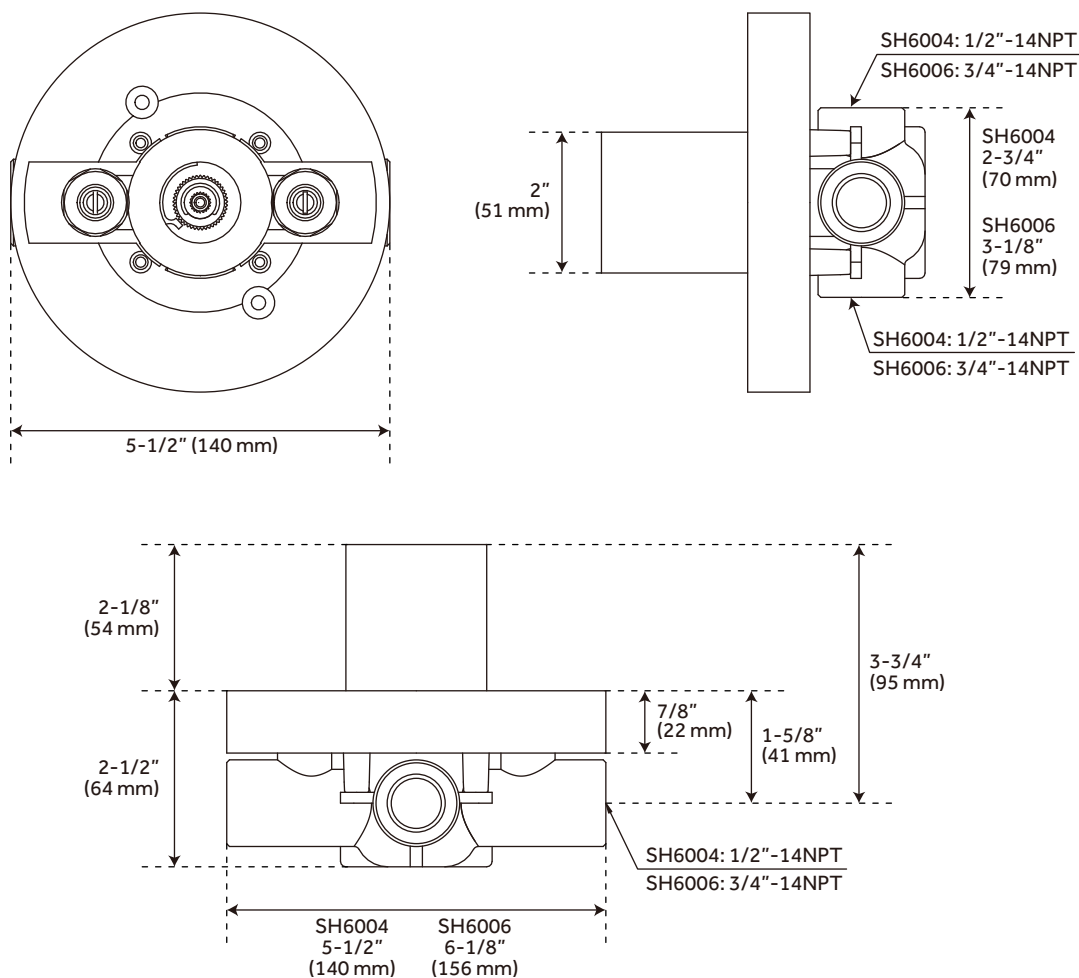

### FEATURES

- Bronze Valve Body
- Ceramic Cartridge
- Integral Water Stops and Check Valve
- Recommended Valve Installation Depth 1-5/8" to 2-3/8"
- Must Be Installed in Accordance With Provided Installation Instructions

### CODES/STANDARDS

- cUPC
- ASME A112.18.1/CSA B125.1
- ASSE 1016 Type T
- Massachusetts Accepted

### PRODUCT IMAGE



All dimensions and specifications are nominal and may vary. Use actual products for accuracy in critical situations.

PAGE 3  
Code: SH6004, SH6006