

### Features

- Fixture-mount design.
- Retrofit models require a control stop and vacuum breaker.

### Material

- Brass construction.

### Technology

- Electronic infrared sensor with Tripoint™ technology for accurate activation.
- Includes a 30-year hybrid energy cell.
- Slow-closing piston technology.

### Installation

- Intended for urinal installations with 3/4" spud coupling connection.



ADA

CSA B651

OBC

### Codes/Standards

ASME A112.18.1/CSA B125.1  
CSA B125.3  
CSA B64  
ASSE 1037  
ADA  
ICC/ANSI A117.1  
CSA B651  
OBC

### KOHLER® One-Year Limited Warranty

See website for detailed warranty information.

### Available Color/Finishes

*Color tiles intended for reference only.*

Color	Code	Description
-------	------	-------------

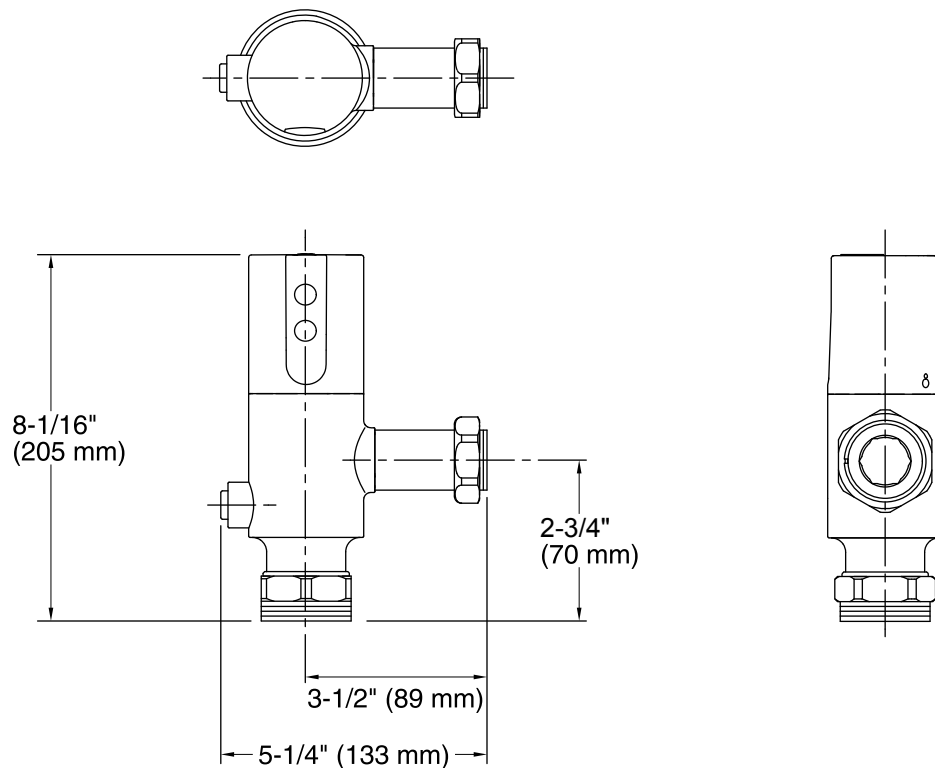

CP	Polished Chrome
----	-----------------

**Technical Information**

All product dimensions are nominal.

**Pressure and Supply Requirements**

Fixture flow rate min: 10 gpm (37.9 lpm)

Fixture pressure max 80 psi (551.6 kPa)  
(static):

Power source: 3.6V Size C (Hybrid Energy Cell), included

**Notes**

Install this product according to the installation guide.

ADA, OBC, CSA B651 compliant when installed to the specific requirements of these regulations.