



**CASWELL™ PRESSURE BALANCE BATH OR SHOWER TRIM
WITH INTEGRATED VOLUME CONTROL WITHOUT DIVERTER**

Modern Caswell™

CA2213LM

FEATURES

- Metal lever handle
- Pressure balanced concealed bath or shower mixer trim for R2012D rough valve with volume and temperature control
- Components made of solid brass
- Complete with plate, escutcheon and handle
- Rotate handle clockwise for hot and counterclockwise for cold
- Move handle up for on, down for off

COLORS/FINISHES

- Polished Chrome
- Polished Nickel
- Satin Nickel

WARRANTY

- Limited Lifetime

To complete package order R2012D rough valve

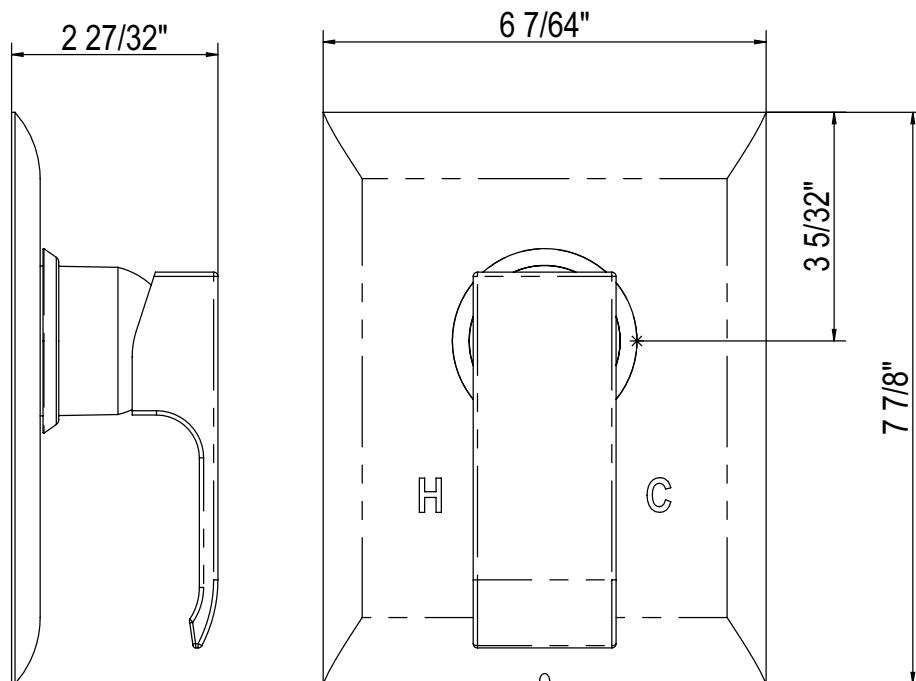

Consult your local FERGUSON showroom for additional information and specifications. www.ferguson.com.