

MODEL NUMBER:

- **M950520-0070A Hard-Wired AC Transformer**
For Selectronic® hard-wired AC products.

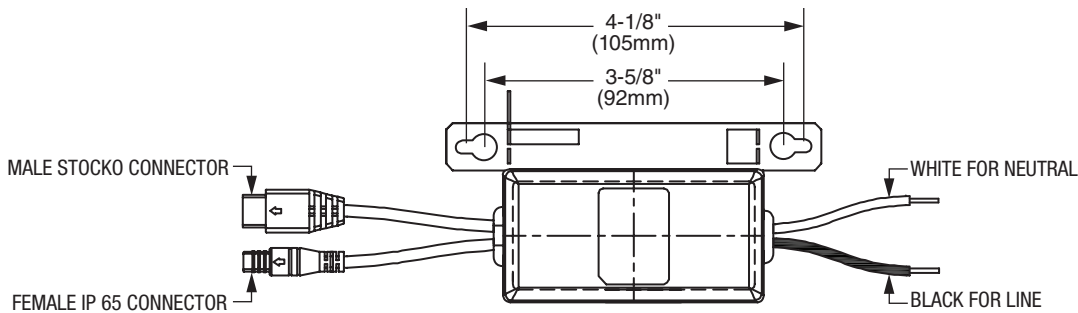
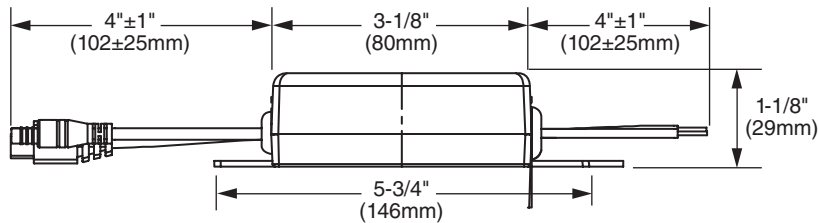
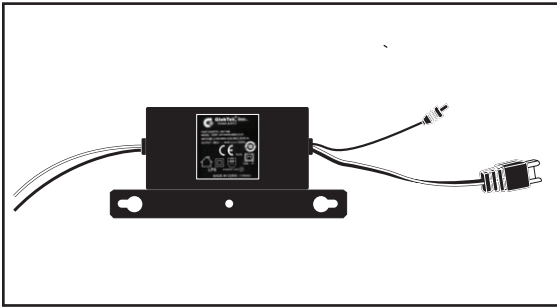

GENERAL DESCRIPTION:

UL-Class 2 hard-wired AC transformer for Selectronic faucets & flush valves. Universal input voltage: 80 - 250 VAC, 50 / 60 Hz. Includes female IP 65 connector & male Stocko connector output connections.

PRODUCT FEATURES:

- UL-Class 2 certified
- Universal Power Supply: same transformer is used for all Selectronic faucets and flush valves
- Input Voltage: 80 - 250 VAC, 50 / 60 Hz
- Output Voltage: 6 VDC
- (2) Output Connections: IP65 female connector & Stocko male connector
- One transformer can run up to 15 faucets and/or flush valves when installed in Multi-AC daisy-chain configuration