

CONSTRUCTION

- Cast iron pump housing and base with dual-suction design.
- **Top suction** (above impeller) eliminates the risk of air locks and suction screen filters debris and minimizes clogging.
- **Bottom suction** (below the impeller) passes up to 1/2 in. solids and filters debris through the heavy-duty, cast iron, multi-ring strainer base, to reduce clogging
- Corrosion-resistant dual-function impeller for maximum performance, and reliability.
- **Centrifugal** designed top portion of the impeller, for ultimate water flow.
- **Vortex** design bottom half of the impeller for quick passing of solids
- Recommended for use in 14 in. diameter or larger effluent tanks
- 20 ft. water resistant, field replaceable, SJTW power cord

SWITCH

- Piggy-back tether float switch for automatic or manual operation
- ON @ 15 in. / OFF @ 7 in.

SEALS

- Carbon / ceramic shaft seal for maximum life

MOTOR

- 120 Volt, high efficiency PSC oil-cooled motor
- Upper and lower ball bearings minimize vibration for ultra-quiet operation. The hardest working pump you'll never hear
- Continuous-duty capable
- 8.3 amp draw

3/4 HP CAST IRON Dual-Suction EFFLUENT PUMP

105 GPM @ 5 FT.



3/4 HP



DIMENSIONAL DATA (INCHES)

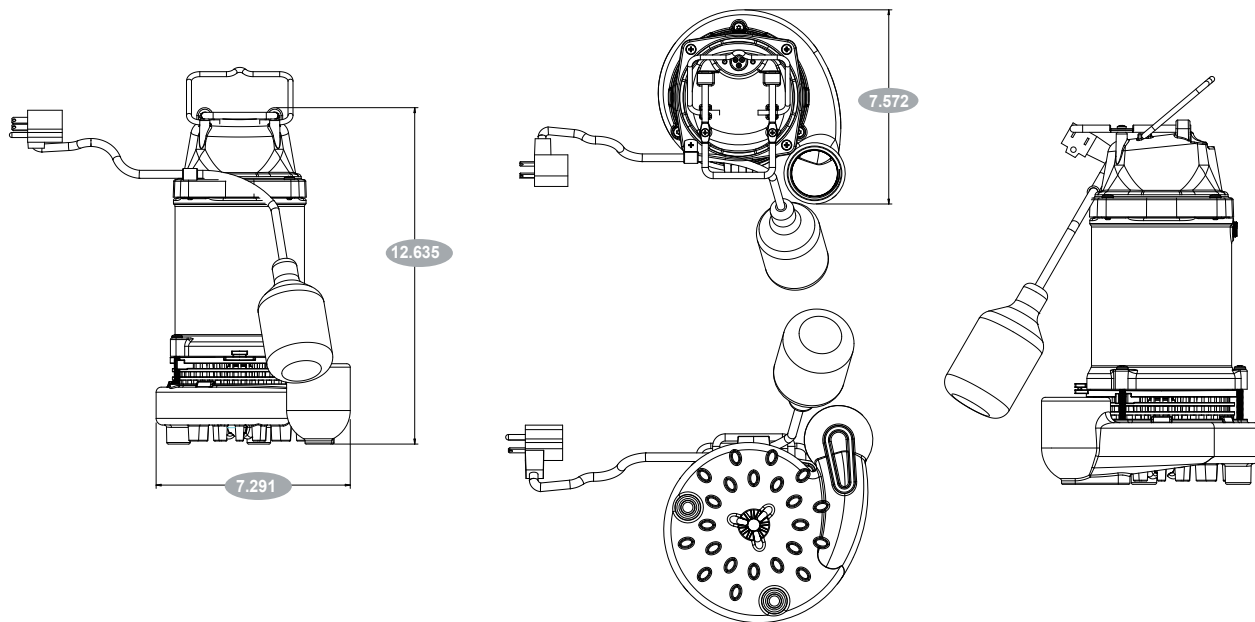

PUMP SNAPSHOT

		Dimensions (in.)							
HP	Construction	Switch Type	Length	Width	Height	Weight	Volts	Footprint	Power Cord
3/4	Cast Iron	Tether Float	7.572	7.291	12.635	24 lbs	120	7.572	20 ft.
Impeller	Intake	Discharge	Submersible	UPC 0-40066					
Centrifugal/ Vortex	Top Suction/ Bottom Suction	1-1/2 in. NPT	Yes	218247					

TYPICAL INSTALLATION

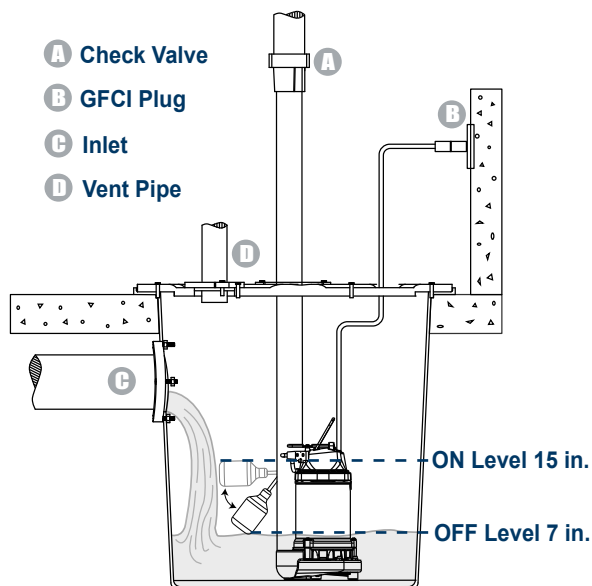

T75DSE PERFORMANCE

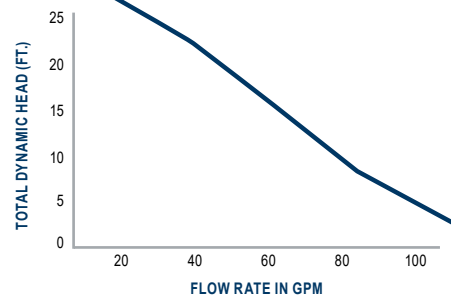

Discharge Head	5 ft.	10 ft.	15 ft.	20 ft.
GPM	105	92	78	63